

CLAIRE MENG

Industrial Designer • Portfolio

PROJECTS

I. Easy Peeler

Makes the whole peeling process easier and quicker.

II. Garlic Crusher

A tool that makes crushing garlic virtually effortless.

III. Candy Light

A perfect bedtime companion that comforts and calms children.

IV. CERTpack

Backpack system for Community Emergency Response Team.

V. Noshi

The scale for the modern day home.

VI. Cuartel

A bench inspired by nature designed for the courtyard of an art gallery.

VII. Takeaway

A food container for sustainable restaurants.

VIII. Fishy

A fishing rod which make fishing easier and more comfortable for any level of angler.

IX. Trackman

A tracking system for efficient rescue in a disaster .

X. Biocan

Being environmentally friendly starts in your kitchen

XI. Substitute

A shoe that allows the user to customize their cushion support.

XII. Peak

A modern, elegant, and compact coffee machine.

Claire Fanyi Meng

mongfanyi@gmail.com

Claire_meng@hotmail.com

240-499-4635

MFA Industrial Design

Academy of Art University

[Easy Peeler]

After peeling fruits and vegetables, there's always a mess left behind to clean up in and around the sink. If the peeling process could be simplified to eliminate the extra step of clean up, cooking would be easier, faster, and more enjoyable for everyone.

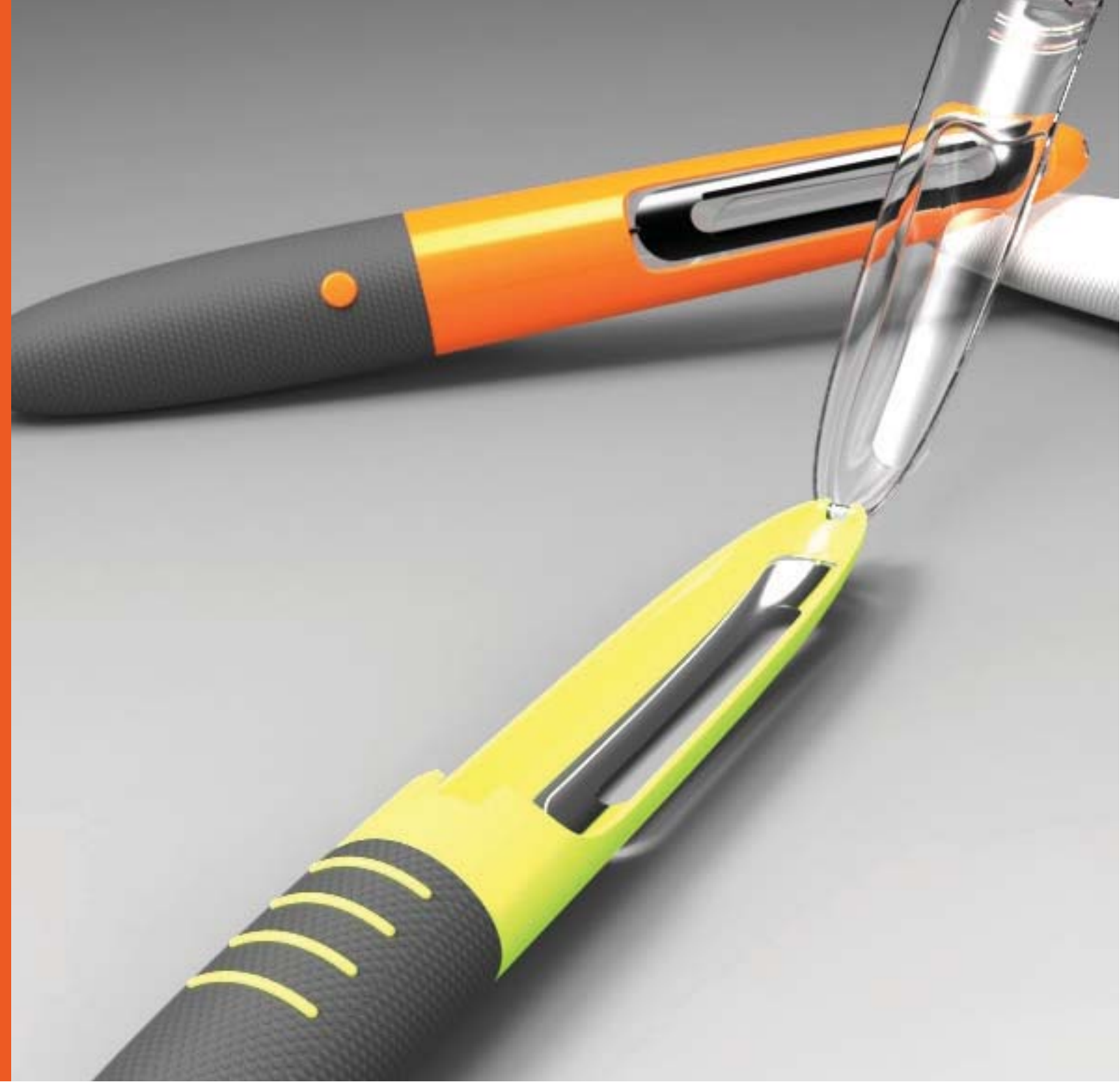



Inspiration

As a person who likes to cook, I always find it annoying that I have to clean the sink after peeling vegetables. Peels get all over the sink and counter, and I have to either pick them up or push them into the garbage disposal. If there were a way to reduce the effort in cleaning up the mess, the whole peeling process would be easier and quicker.

Concept Development

I developed various concepts of peelers that contain the peel while peeling.

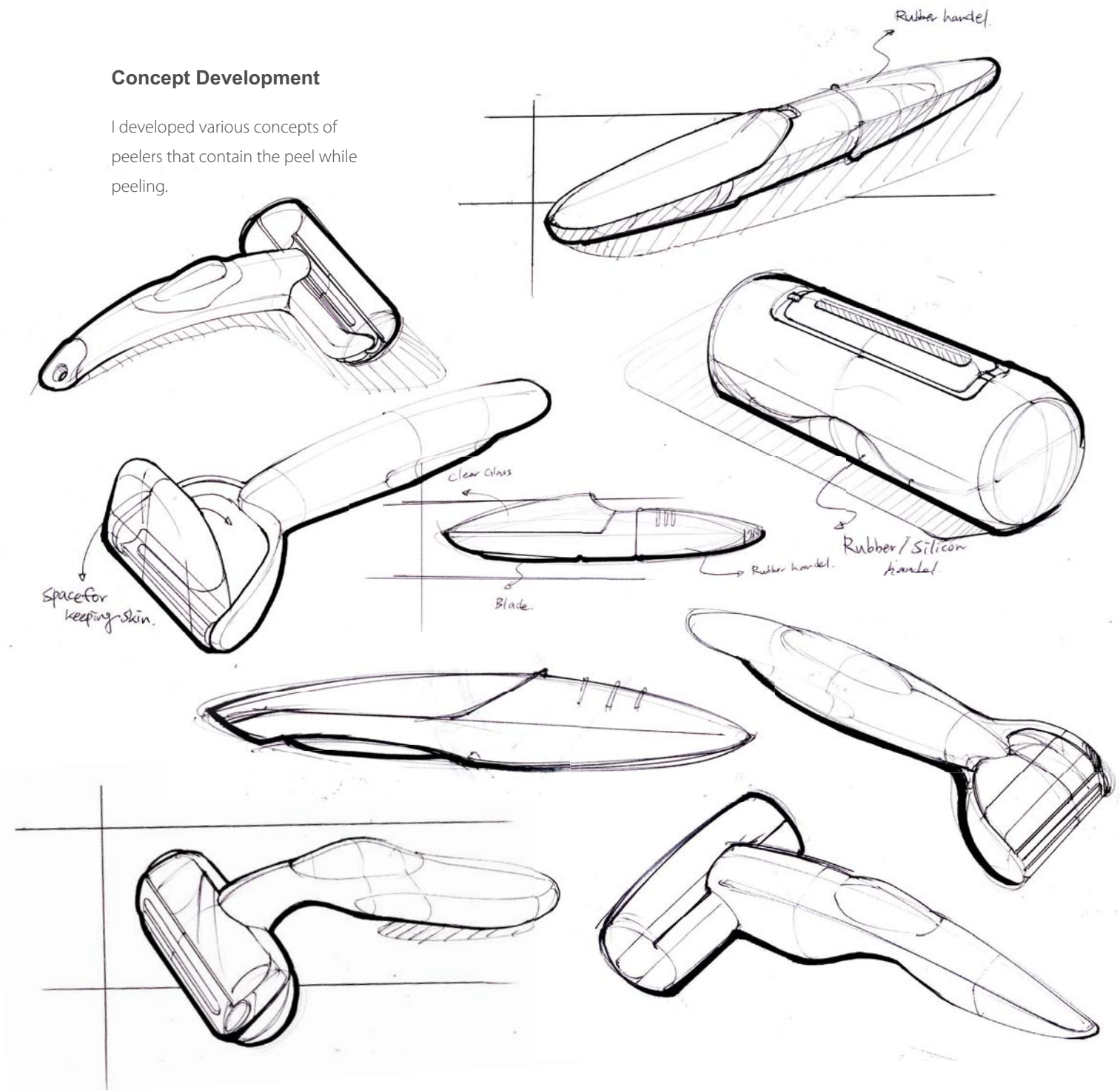



Design Features

- Comfortable rubber grip for a better hold while working.
- Swivel blade follows the contours of vegetables and fruits.
- Easy to empty when the peel container is full.
- Colorful design fits into various kitchen environments.

Without peels flying around, the user no longer has to stand beside the sink in order to peel fruits and vegetables. Plus, there won't be any mess of peels in the sink or on the counter to clean up. Easy Peeler reduces the effort involved and makes the peeling process easier and faster during cooking.

[Garlic Crusher]

Garlic is a common ingredient in the kitchen and should be stored in a cool, dry place. If there is a product which can combine the storage of garlic with the function of a garlic press, then the user will not have to load the cloves each time they need crushed garlic. Through the use of a simple ratchet mechanism, crushing garlic becomes virtually effortless.





Storage + Crusher = Ready Immediately

Current garlic presses require the users to put the garlic cloves into the tool each time when they need crushed garlic.

Garlic is a very commonly used ingredient in the kitchen. If I could design a garlic press that was as easy to use as a pepper mill, it would make cooking quicker and more enjoyable.

Simple Mechanics = Less Effort Needed

Through the use of a simple ratchet mechanism, crushing garlic becomes virtually effortless.

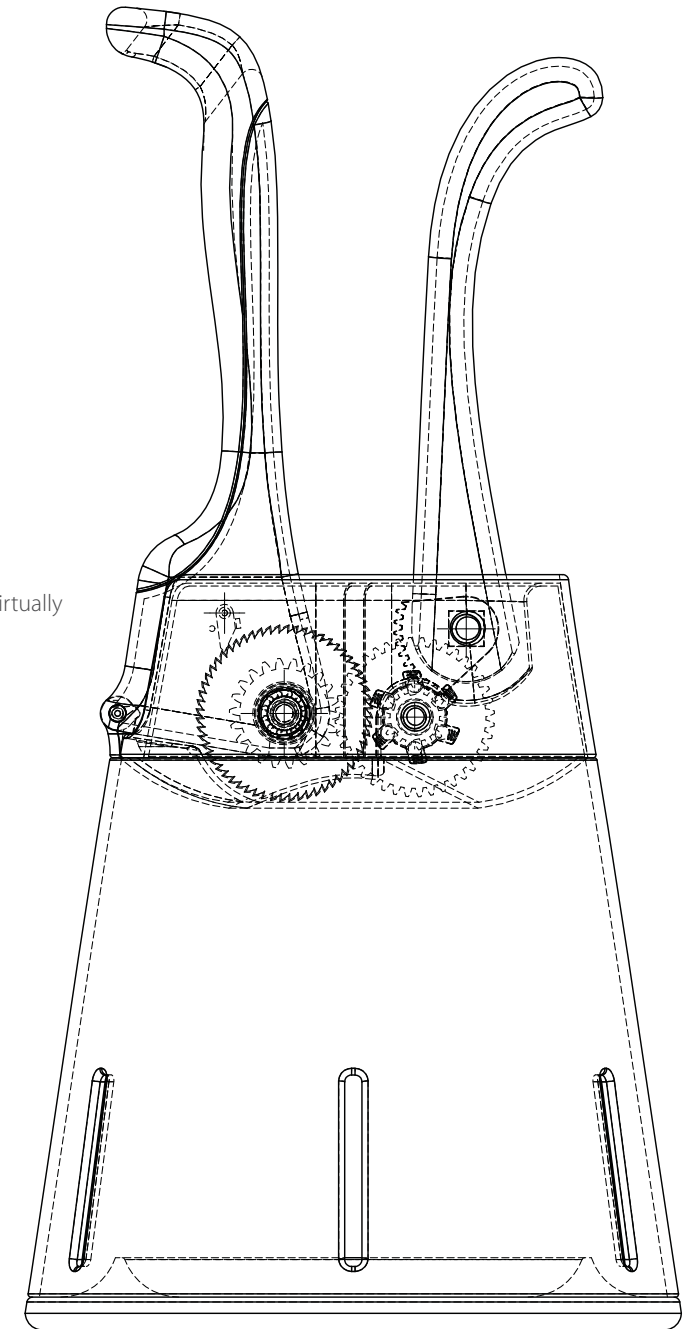

User Scenario

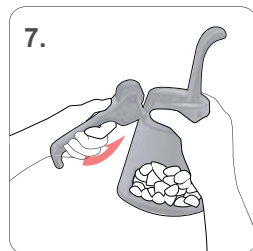
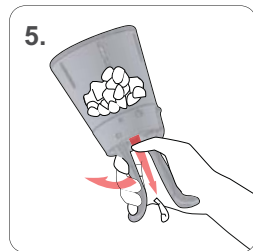
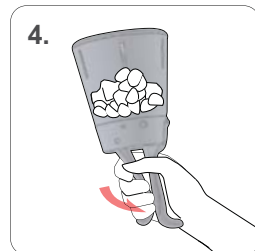
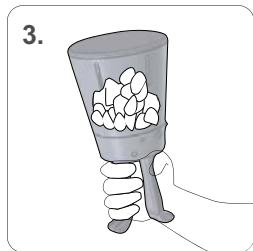
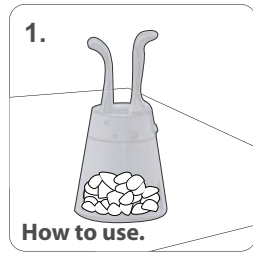

Design Features

- Simple mechanism requires far less effort to use than other presses.
- Efficient: Just hold and press each time you need crushed garlic.
- Easy to clean removable handles.
- Ergonomic: Comfortable rubbery grips for a better hold while working.

[Candy Light]

We can all remember hearing strange creaks at night when things are exceptionally quiet. Or what about the weird shadows and moving figures created by bouncing headlights from cars on a nearby road shining in a bedroom window. These things are enough to make some adults uneasy, let alone children!

Candy Light provides just the right amount of light to help children go off to sleep, without fear of the dark.





Inspiration

Light entices the child to explore and inspire them to be creative. But many children are afraid of the dark. A child's fear may disrupt their bedtime routine and sleep. Candy Light helps to keep monsters away all night long. The perfect bedtime companion for any child or baby.

Concept Development

I have come out various ideas of night-light, based on the object that children may like.

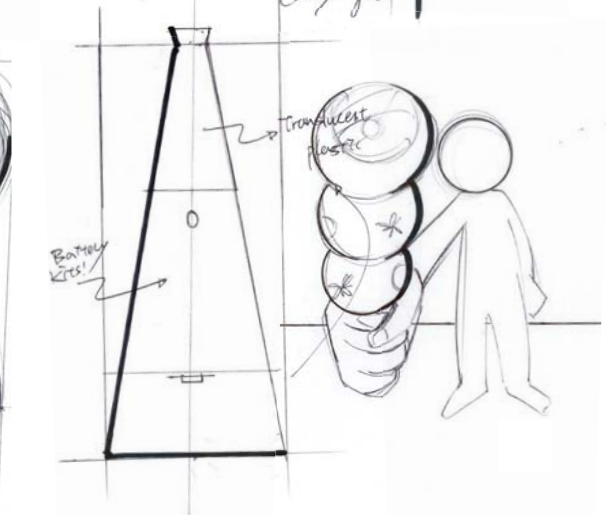
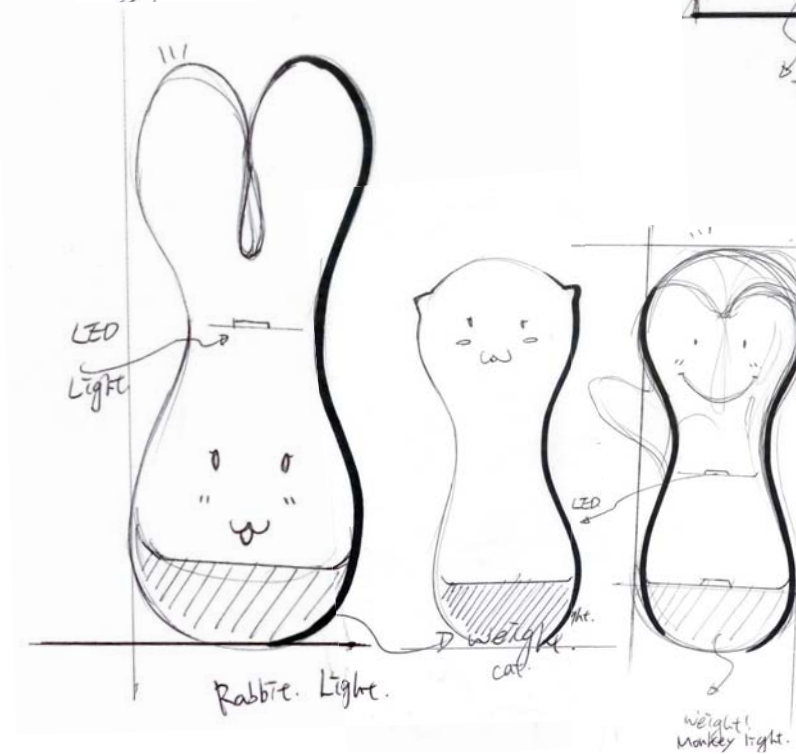
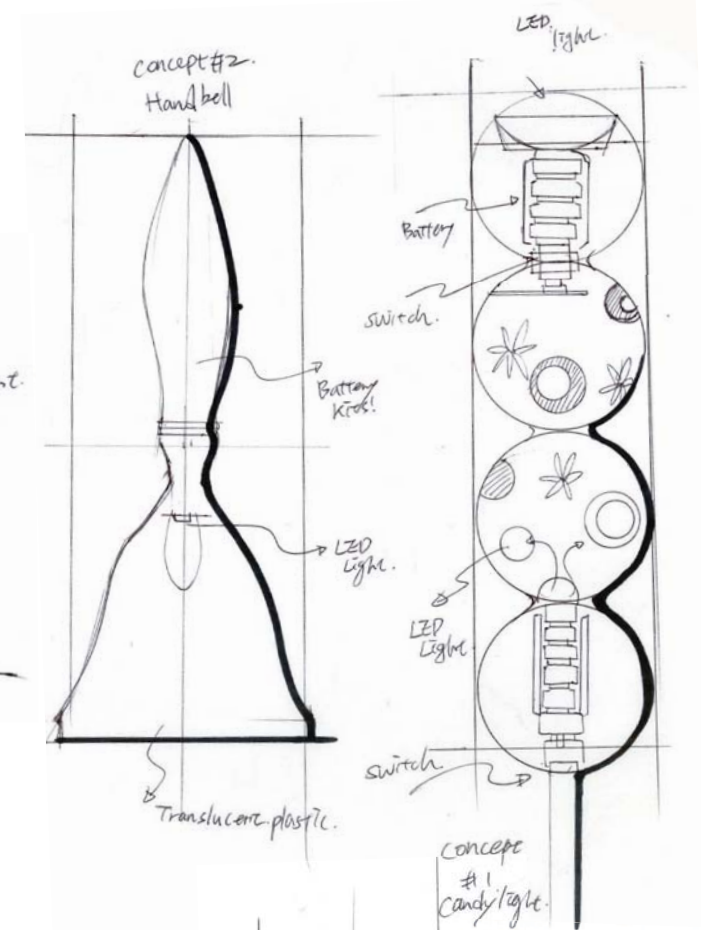
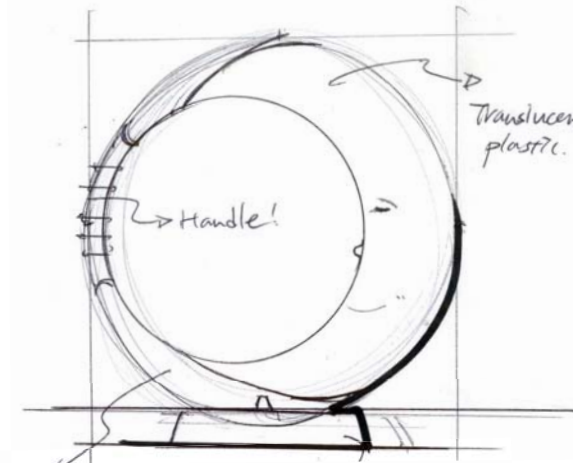



[Candy Light]

A perfect bedtime companion
that comforts and calms children.

Design Features

There are two switches to allow the parent to adjust the amount of light. The first switch can turn on the headlight to light up a larger area. Another switch can turn on the embedded LED nightlight and provide just enough light to comfort children but not disturb their sleep.



[CERTPACK]

Backpack System for Community Emergency Response Team

Of all natural disasters, earthquakes have caused the highest number of deaths in the last ten years. The event that happened in Haiti inspired me to think about what I could do for earthquake victims as an industrial designer. Due to the fact that the ratio of rescuers to the population is decreasing over time, residents would most likely be on their own for a period of time after a major earthquake. Through the Community Emergency Response Team (CERT) program, residents have the ability to save lives by providing simple treatment during a disaster. If we can help CERT members work easier and faster, the rescue process would be quicker and there would be fewer deaths from earthquakes.





What is CERT/NERT?

CERT/NERT is government program to train the local resident as an emergency responder. In class, residents will learn emergency rescue skills, such as: fire safety, light search and rescue, disaster medical operations; therefore, if an event happens in community, they can react first even before professional rescuers arrive.

Project Overview

The goal of the project is to enhance the speed of the rescue process by improving the backpack for Community Emergency Response Team (CERT) / Neighborhood emergency response (NERT) members during and after earthquakes.

Problem statement

After a catastrophic earthquake, there will be more victims than rescuers and immediate help will not be available. Therefore, community emergency responders (CERTs) must be able to function quickly and efficiently to save lives. However, the current equipment slows down the speed of rescue which translates into the need for extra manpower and resources to complete the rescue process.

Hypothesis

If there is a product, device, and/or system, that can make the rescue process more efficient, then not only could CERT members save more lives, but also injured victims would have higher chances of survival during and after an earthquake.



Current CERT backpacks

Utility Control

User Scenario

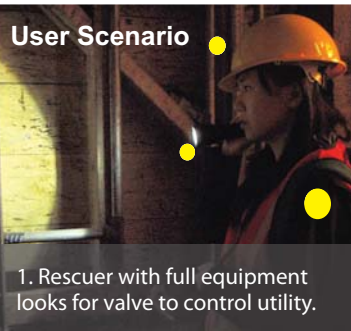

1. Rescuer with full equipment looks for valve to control utility.



2. Rescuer takes off the backpack to search for the utility control tool.



3. Rescuer has to hold a flashlight to help in looking for the tool.



4. It is difficult to use only one hand trying to search through the backpack.



5. Rescuer has a hard time zipping up the backpack when holding large tools.

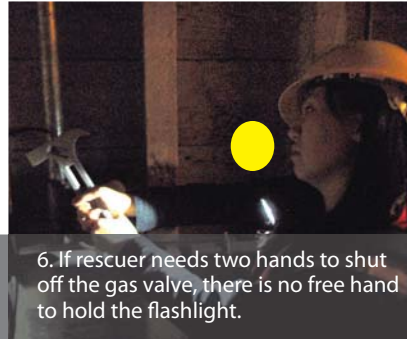

6. If rescuer needs two hands to shut off the gas valve, there is no free hand to hold the flashlight.



1. Conduct voice triage. Begin by calling out, "Emergency Response Team. If you can walk, come to the sound of my voice."



2. Rescuers go inside the room and follow a systematic route.



3. Depending on the location of patients, rescuers may have to work in tight spaces.



4. Rescuers find the patient, and have to remove fallen objects on top of injured victims and begin triage right away.

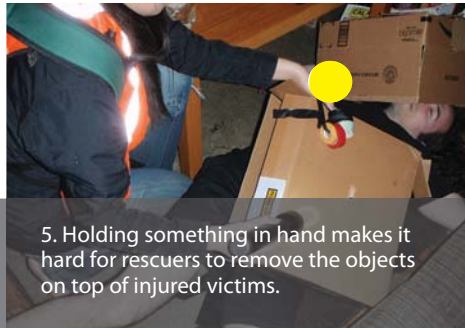

5. Holding something in hand makes it hard for rescuers to remove the objects on top of injured victims.

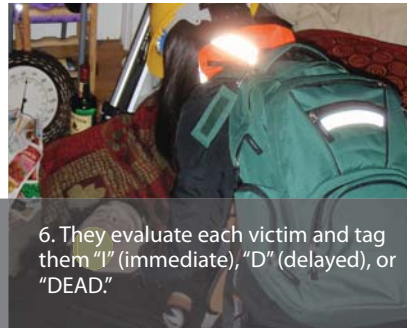

6. They evaluate each victim and tag them "1" (immediate), "D" (delayed), or "DEAD."



7. It is hard for rescuers to recognize the color of tape in the dark environment.



8. Rescuer ties the tape on patient's wrist.

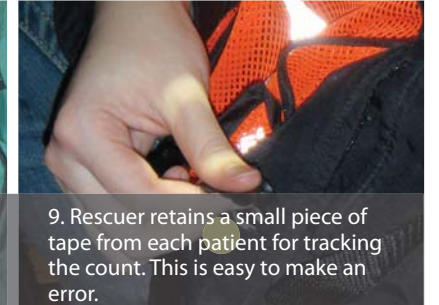

9. Rescuer retains a small piece of tape from each patient for tracking the count. This is easy to make an error.



1. Generally CERTs have to find resources on the site or use whatever is on hand to perform medical treatment.



2-1. After rescuer finds resources, they use scissors to cut materials to the proper size.



2-2. If rescuer has a medical kit, they have to take off their backpack to access it.

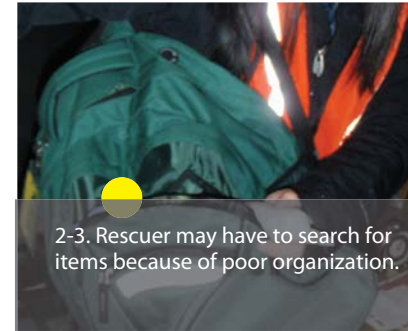

2-3. Rescuer may have to search for items because of poor organization.



2-4. Rescuer may have to put the bag on the floor for easier access during medical treatment.

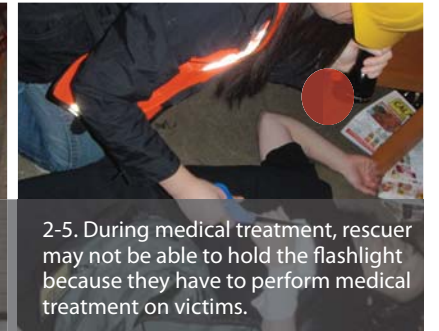

2-5. During medical treatment, rescuer may not be able to hold the flashlight because they have to perform medical treatment on victims.



3. Rescuer has to access the bag again for duct tape to fix the bannage.



4. Rescuer needs both hands to wrap it up.

Problems of Current CERT Backpack

The current backpack CERT provides is a typical backpack; it is not designed to meet the user's needs during a rescue operation.

Therefore, it reduces speed and poses potential dangers for CERT members. This reduces the rescuers' efficiency and in effect increases the need for more manpower to complete the rescue process.

- Single compartment- All personal and rescue equipment are mixed together and requires CERT member to take off the bag each time to access tools.
- Netting used- CERT members may work in tight spaces and could get caught because of the use of net or wire.
- Dark color- In reality, CERT members will most likely work in dark environments such as inside a building without electricity. It is necessary to use a highly visible color to help CERT members stand out from the background and to provide greater visibility during nighttime work.

Rescue Scenario

Early Concept Sketches

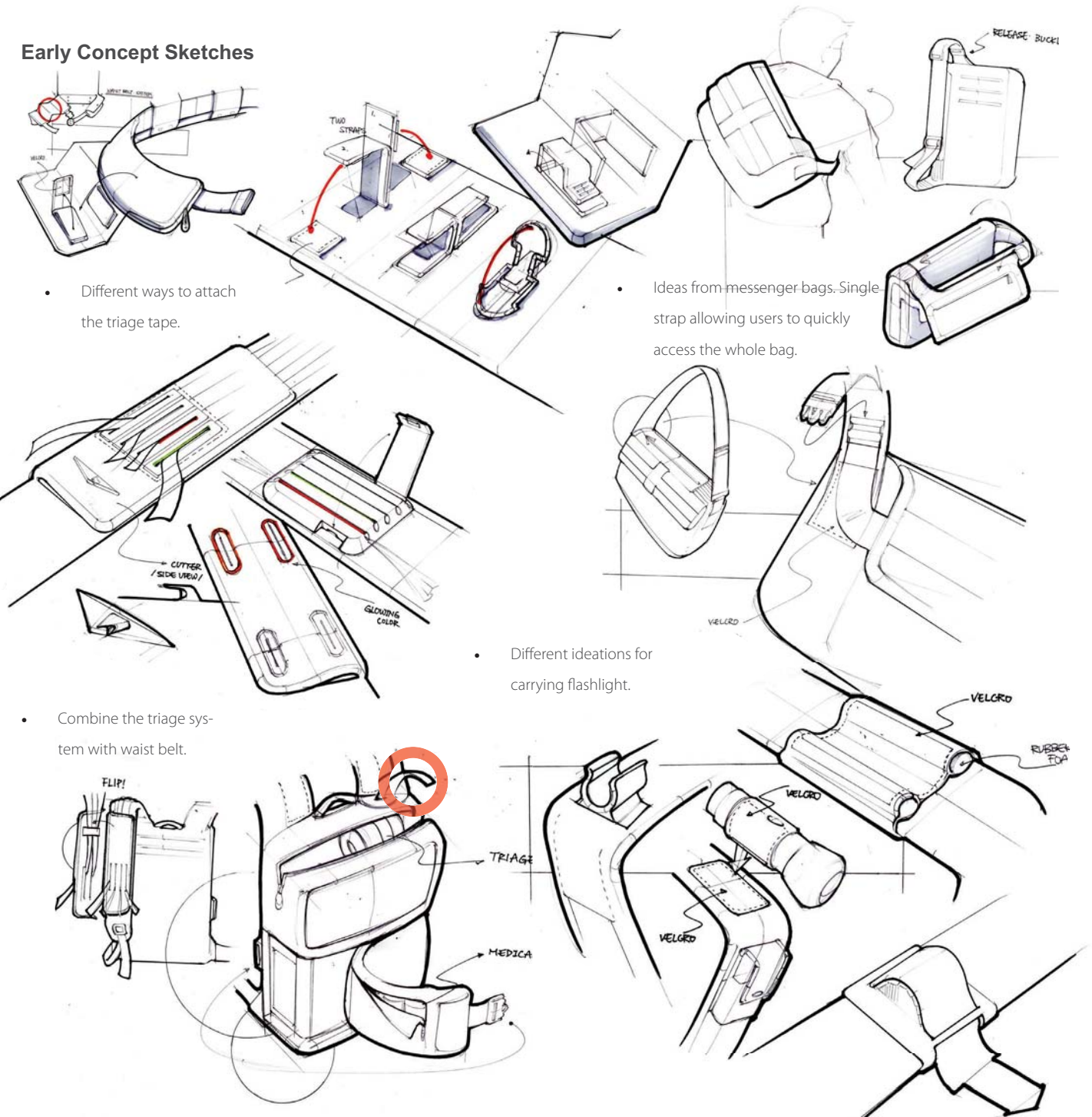



-Neighborhood Emergency Response Team/NERT Annual Citywide Drill

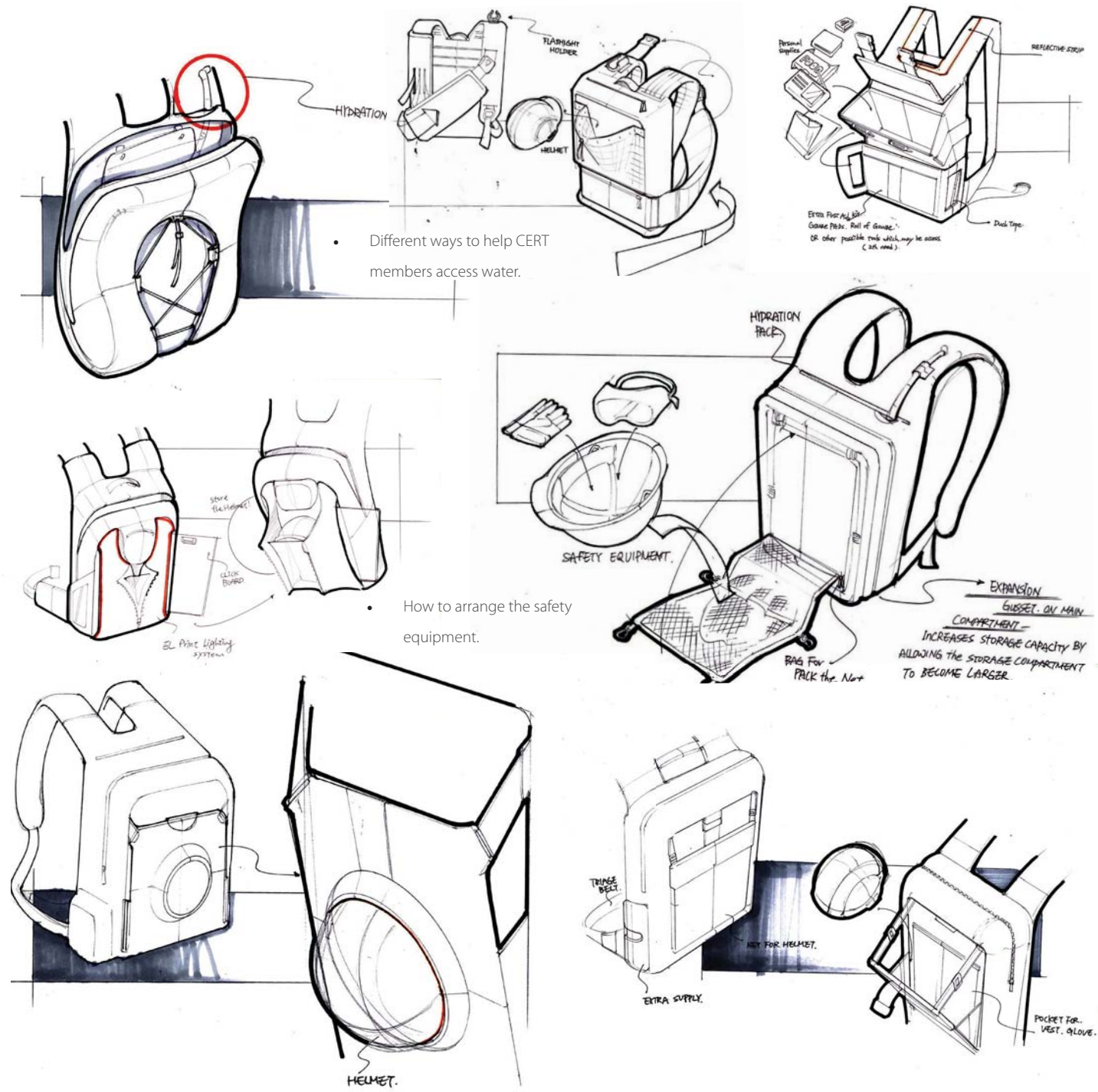



1. Before operations.

First Mock-up



2. Release the buckle in the back.



3. Pull the belt from back to the front.



4. Rescuers can access important medical devices in the front.



5. Triage belt should be beside your hip.

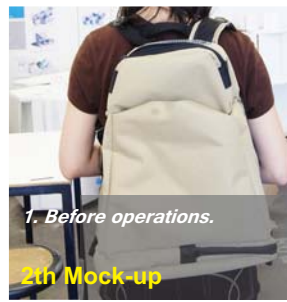

1. Before operations.

2th Mock-up

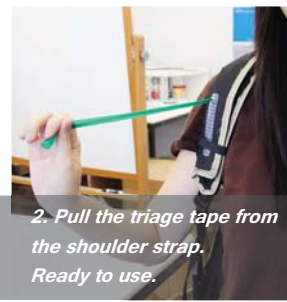

2. Pull the triage tape from the shoulder strap. Ready to use.



3. Release the clip from side of the bag.

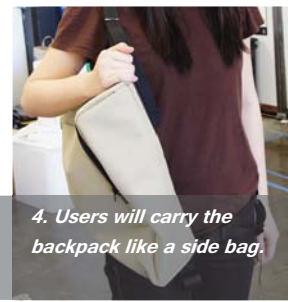

4. Users will carry the backpack like a side bag.



5. Users can easily access the tools in the bag.



1. Before operations.

3th Mock-up

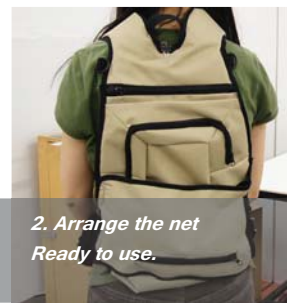

2. Arrange the net Ready to use.



3. Unzip the triage compartment.



4. Wrap the velcro straps around the thigh. Ready to use.

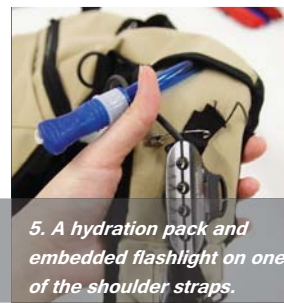

5. A hydration pack and embedded flashlight on one of the shoulder straps.

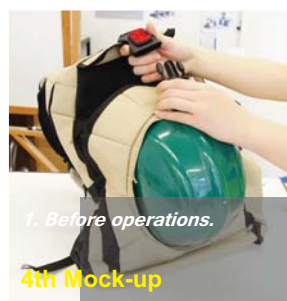

1. Before operations.

4th Mock-up



2. Turn on safety light.



3. Triage system wrap around the thigh.

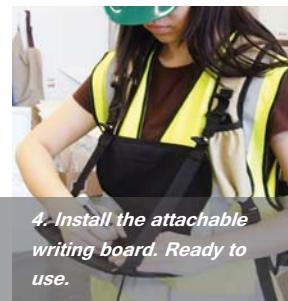

4. Install the attachable writing board. Ready to use.



5. Easily grab utility control tool at the bottom of the backpack.



1. Before operations.

5th Mock-up



2. Easy to take out the helmet.

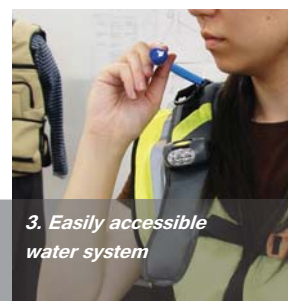

3. Easily accessible water system

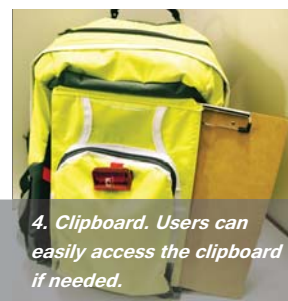

4. Clipboard. Users can easily access the clipboard if needed.



5. A special compartment for duct tape, allowing users to access tape more easily.



Final product

Final Design

Design features



- A glowing name tag to help rescuers identify each other while working in the dark.



- Expandable compartment to store a helmet.



- Helmet compartment zips neatly away when not in use.



- Compartment for commonly used tools.



- Easy access to communication tools.



- Built-in flashlight in the front improves visibility in dark environments and allows users to use both hands for other tasks.



- A special compartment for duct tape allows users to access tape more easily.



- Triage system allows users to see how much tape remains and refill it easily.



Final Design

Design features



- Users can easily separate the backpack and waist belt.
- Easily separated backpack and waist belt allows users to access their personal items when they are working.
- Clean surface without using net or wire, reducing the potential dangers for CERT volunteers.
- Special compartment for the utility tool for quick access.



- Clipboard storage allows users to easily access a clipboard.
- Expandable capacity allows users to carry heavier loads.
- An easily adjustable triage system.



Earthquake Relief:

CERTPACK

Backpack System for Community/Neighborhood Emergency Response Team

[Noshi]

Design Within Reach aims to fulfill the desire to bring the quality and comfort into our daily lives. The goal of this projects was to design a residential object that enhances the user's experience while incorporating the design language of Design Within Reach .

Noshi is a traditional folded origami packet which is attached to gifts to express "good wishes". The expression of origami is clean, simple and elegant, just like the language of Design Within Reach.



Polypropylene (PP)

Interior

- .Heat Resistant
- .Food Safe
- .Easy to Clean

Anodised Aluminium Exterior

- .Smooth Matte Finish
- .Oxidisation-Resistant
- .Relatively Eco-Friendly Manufacturing

Digital Display

- .Tilted for Easy Reading
- .Maximum Accuracy

Graduations

- .Situated on a Slanted Plane
- .Cups, ounces, tablespoons

Packaging

- .Japanese Origami Technique

Spout

- .Practical for Liquids
- .Wide for Easy Pouring and Bulky Ingredients

Stable Base

- .Sits on Counter for Reading
- .Tapeable Surface to Level out Ingredient

What Are The Problems?

Baking is more like a chemical reaction compared to other forms of cooking. In order to get successful results, measuring is necessary.

The most common measuring scales on the market consist of a flat surface with small LCD screen. When in use, the screen may be obstructed by the bowl or plate being weighed making it difficult for the user to read the scale.

During the baking process, generally one will use at least 3 different measuring tools to measure the different types of ingredients such as: cups for liquid, scales for weight, and spoons for volume.

Cleaning utensils and storage after use also complicate the baking process for all levels of bakers.

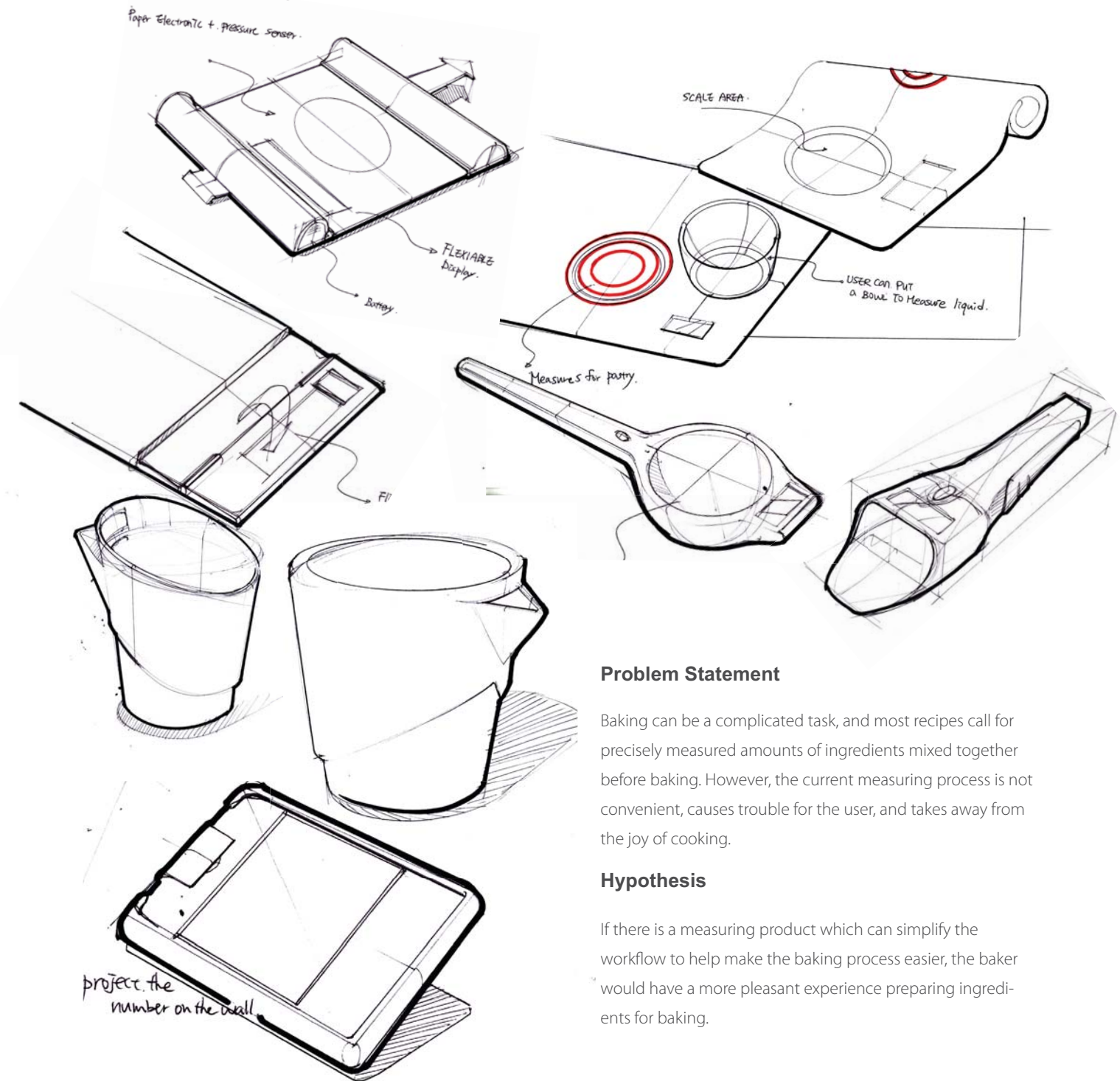
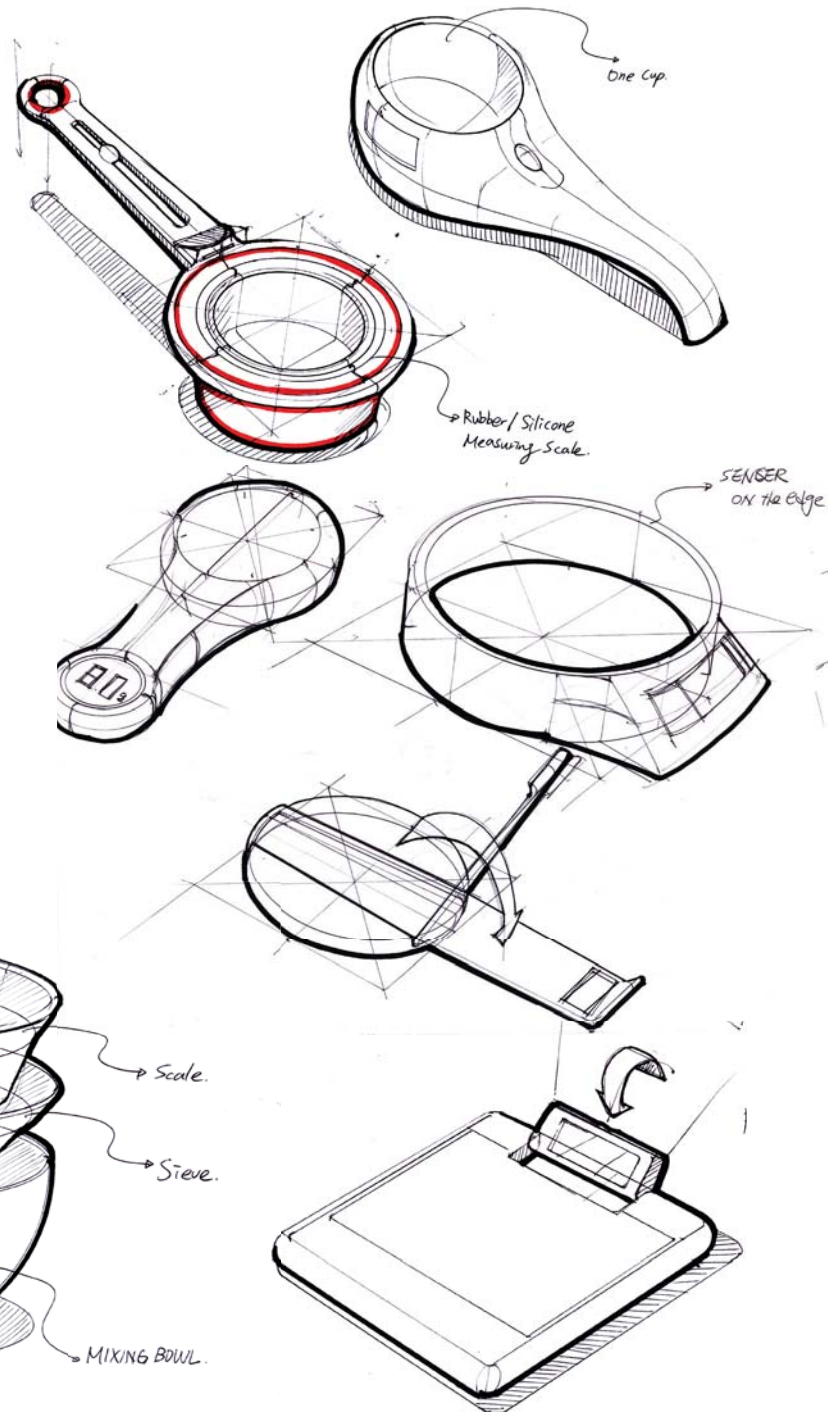

Problem Statement

Baking can be a complicated task, and most recipes call for precisely measured amounts of ingredients mixed together before baking. However, the current measuring process is not convenient, causes trouble for the user, and takes away from the joy of cooking.

Hypothesis

If there is a measuring product which can simplify the workflow to help make the baking process easier, the baker would have a more pleasant experience preparing ingredients for baking.



Design Features

Instead of positioning the digital screen in the bottom of the device, Noshi's screen is designed to be viewed at a comfortable angle. The user can easily read the display without any effort.

Noshi combines all the features of measuring weight and volume into one object, therefore, the baking process is simplified. Measuring is no longer a barrier of successful baking.

The handheld size allows the user to easily hold it and even spoon out the contents. Noshi is dishwasher safe making cleaning easy.



The Scale For The Modern Day Home

Simplicity, Compact, and Stylish. Noshi enhances the experience by helping the baker get precise measurements more easily.

As a person who loves to cook, I like to bring clean, simple, and elegant designs into the kitchen that make the cooking process more enjoyable and comfortable.



[Cuartel]

Cuartel, to be located at Valencia and 20th, is a collaborative design project with an architecture designer to create a new building along with a harmonious environment around it.

I designed a pair of benches located in the center of the gallery courtyard which reflect the inspiration of the building.





Design Inspiration

Cuartel is an art gallery designed to express the meaning of beauty. My architecture partner Sergio Ormachea and I both agree the core of the beauty comes from Mother Nature.

Wind blowing, water flowing, spiral shells -- all these embody natural elegance in curvatures and form which we experience during our daily lives. We wanted to create a space, not just as a place to display lovely works of art, but one in which the building itself could reflect the beautiful art seen in nature.

Based on this understanding, we made use of natural wood and the spiral shape as the basic foundation of the design for Cuartel. We chose to keep it in simple, casual, and comfortable so it could match the environment of Mission District.

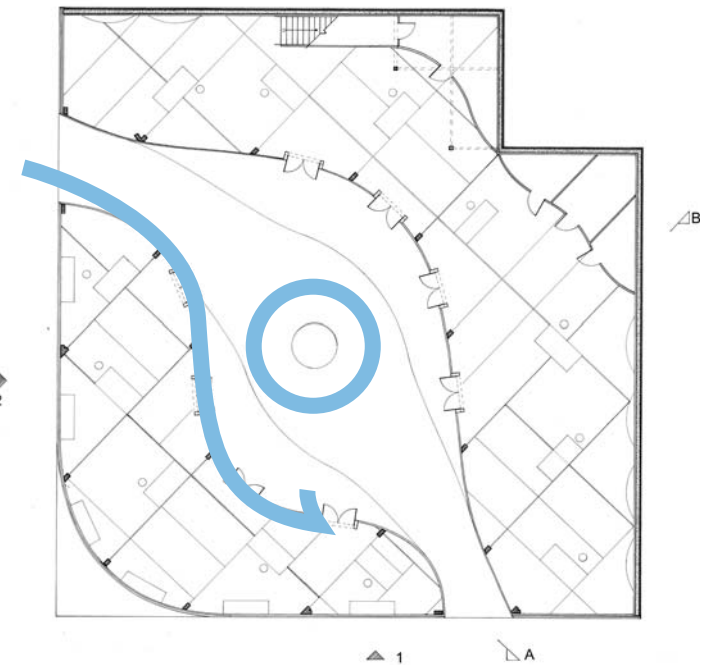
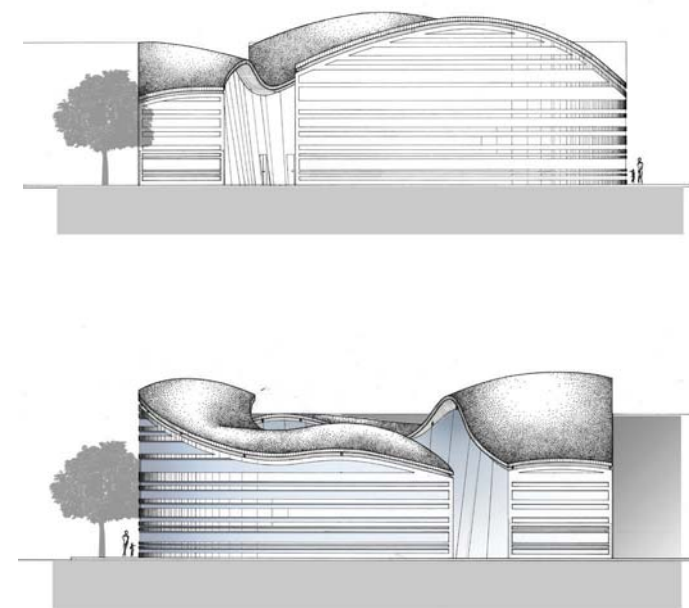

Cuartel Art Gallery

Cuartel is a two floor building with two sections which are separated by a center plaza. The first floor is for an art gallery and a work shop which allows a family to not only enjoy the art but actually participate the process of creation and interact with artists. The second floor has a reference library with a lounge area for artists to rest.

During summer, wind is frequently blocked by Twin Peaks causing this area to be hotter than other nearby neighborhoods. Therefore, based on geographical concerns and with inspiration from the natural world, Sergio designed the spiral shape with two entrances to enhance air circulation.

The outer wall is glass covered by wood strips. People could easily see through the glass exterior and view the exhibitions.

In the center of plaza are outdoor benches designed in response to the building.

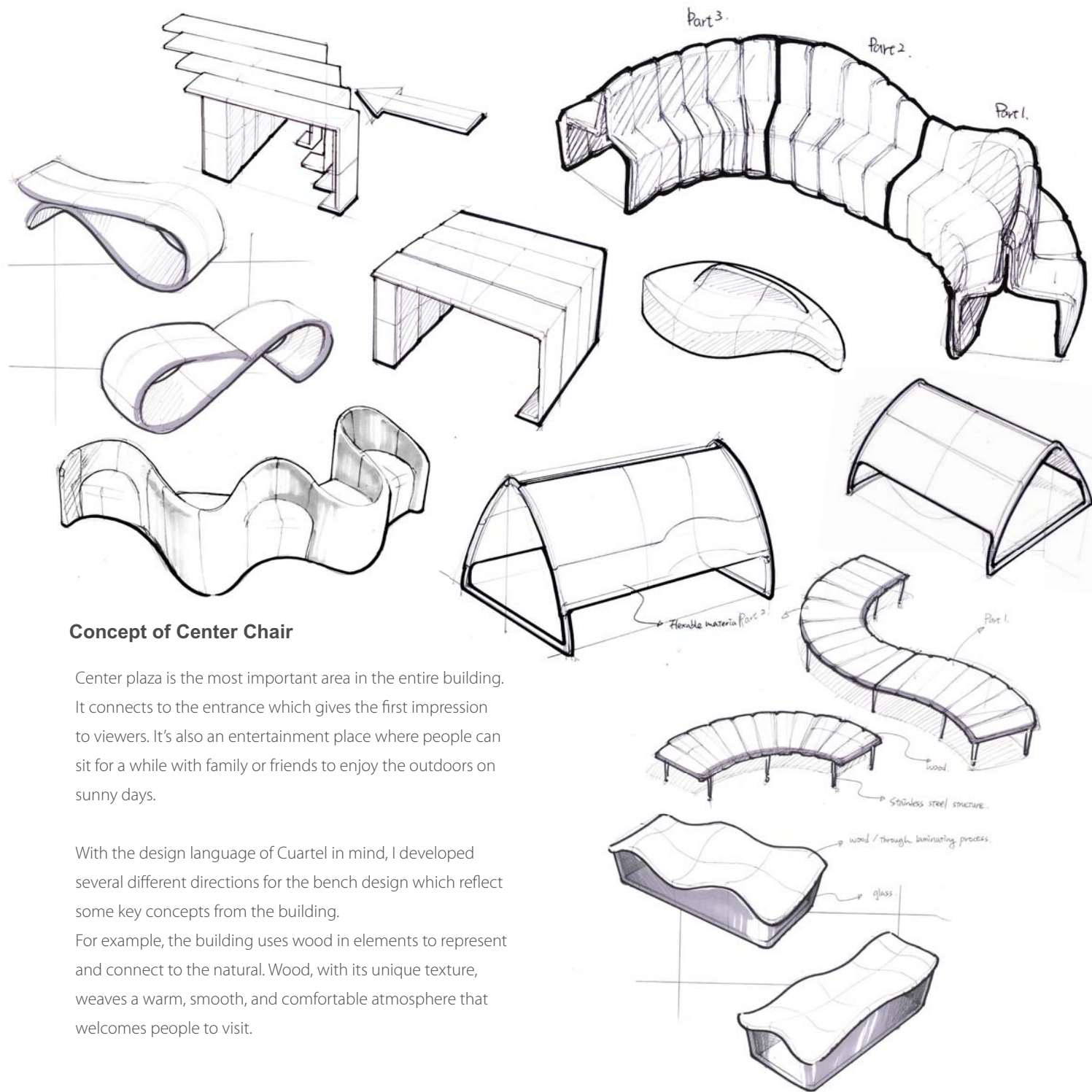

Cuartel+Pair

Concept of Center Chair

Center plaza is the most important area in the entire building. It connects to the entrance which gives the first impression to viewers. It's also an entertainment place where people can sit for a while with family or friends to enjoy the outdoors on sunny days.

With the design language of Cuartel in mind, I developed several different directions for the bench design which reflect some key concepts from the building. For example, the building uses wood in elements to represent and connect to the natural. Wood, with its unique texture, weaves a warm, smooth, and comfortable atmosphere that welcomes people to visit.

Center Chair

After discussion with my partner, we chose Pair to be the center chair of Cuartel. As you can see from the top view of the building, the entryways of the building create a circulation that forms a shape like the Chinese yin and yang. Yin and yang are used to describe how polar opposites or seemingly contrary forces are interconnected and interdependent in the natural world. Therefore, we chose this design which consists of a two-piece wood sculpture inspired by the form of yin-yang. The design responds to the shape of the building while also giving the space in the center of the complex a sense of movement and flow.





[Cuartel]



Cuartel + Pair

Cuartel is an art gallery that not only exhibits beautiful artworks, but it is also a bridge that connects the human being with Mother Nature.

Pair incorporates the ancient Chinese yin-yang concept which materializes the natural circulation in the building and harmonizes the connection between human being and nature.

【 Takeaway 】 Food Containers

Current takeout food containers are commonly made of plastic coated paper or PVC plastic. These containers tend to leak and require extra plastic bags to prevent spillage. They not only cause trouble for customer but also have a great negative impact on our environment.

In 2008, Americans spent \$22 billion on food containers, but only half the country has the recycling/composting capacity to deal with soiled paper and plastic.

- Findacomposter site, Facility search





Customer Trends

National Restaurant Association research shows that environmentally sustainable practices are important to today's consumers. Forty-four percent say they are likely to make a restaurant choice based on a restaurant's efforts to conserve energy and water, and six out of 10 say they are more likely to visit a restaurant that offers food that was grown in an organic or environmentally friendly way.

Problem Statement

Current takeout food containers tend to leak. Therefore, restaurants have to use extra plastic bags to prevent leakage.

Hypothesis

A takeout box that has better leak prevention and is also environmentally friendly would be a benefit to the restaurant, the end user, and the environment.

Goal

Design a food container that is not just more convenient for customers but also has less impact on the environment.

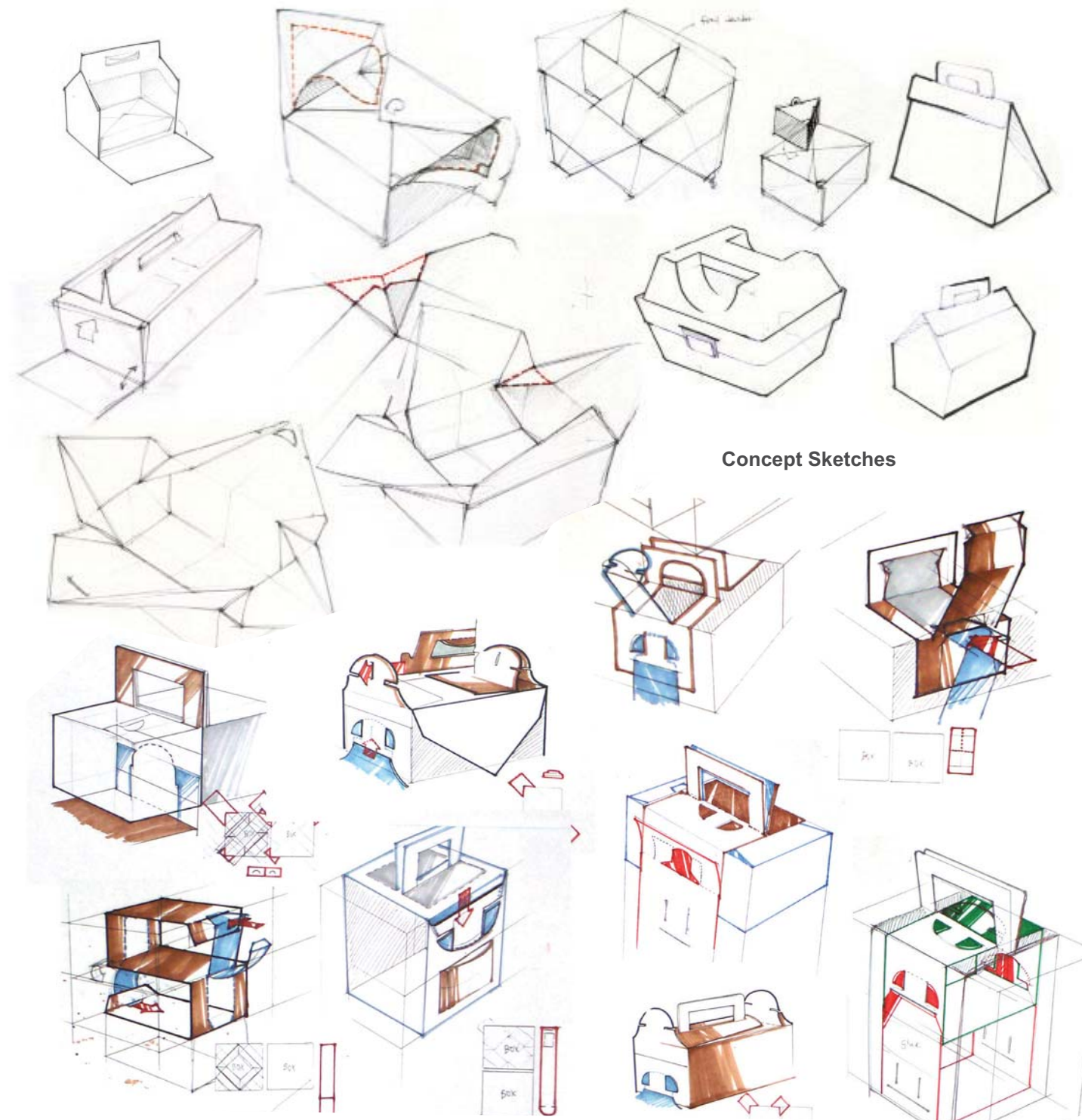

Concept Sketches

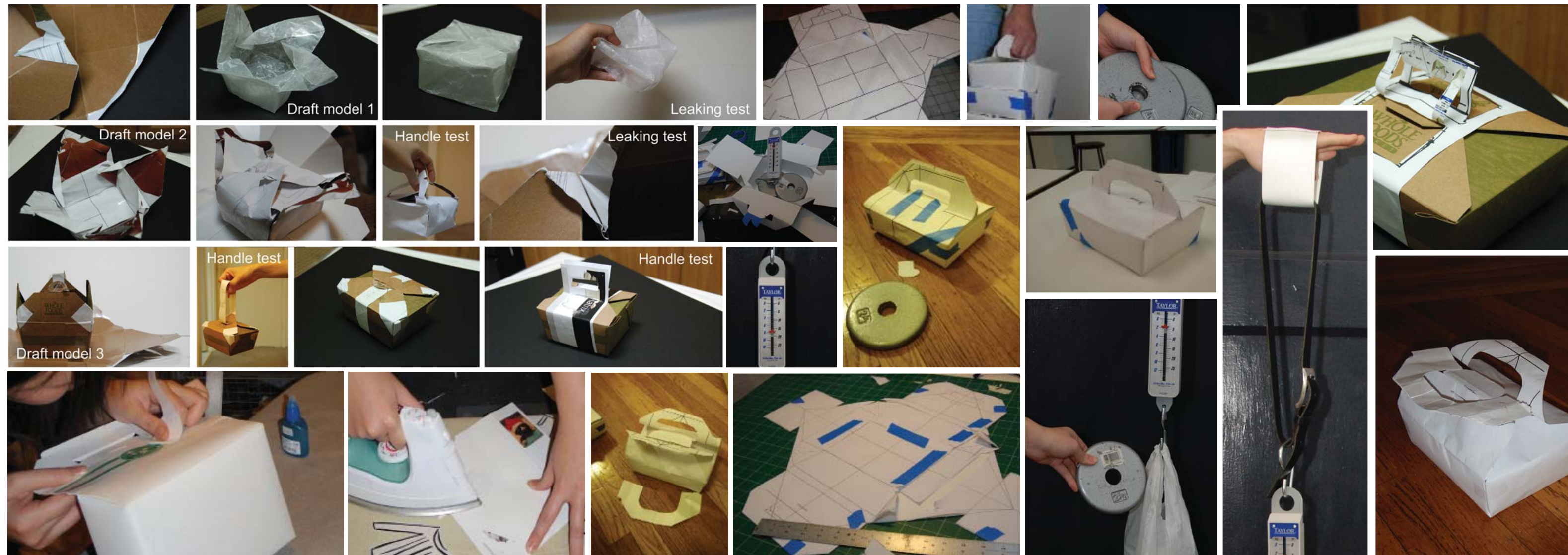

Criteria

Customer needs - User friendly, convenient to use, easy to carry.

Restaurant needs - Stackability, easy to use, easy to fill, low cost.

Environment needs - Biodegradable, low embodied energy.

Based on mockup testing and the criteria matrix, a final design was chosen.

It has to be easy to use for the customer, convenient for restaurants, and most importantly, environmental friendly.

Comparing commonly used biodegradable materials like bio-paper, sugarcane starch, and calcium carbonate, calcium carbonate has lowest environmental impact and has the lowest embodied energy by the end of the recycling process.

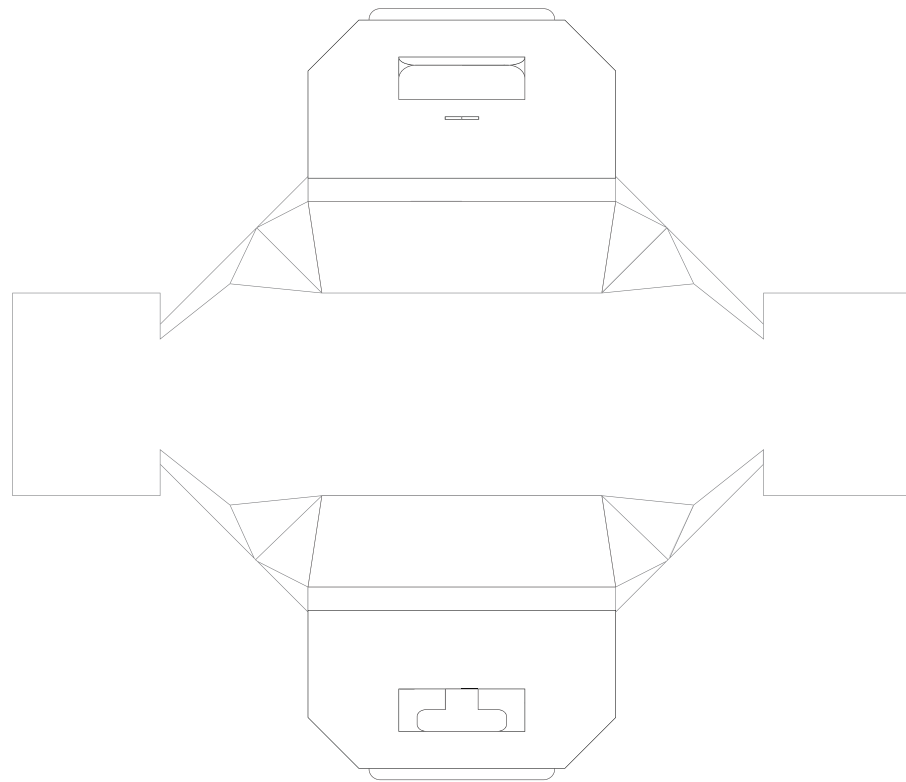

60 X 53 cm

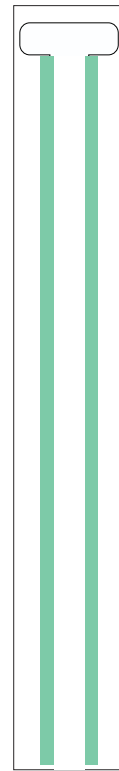

9 X 44 cm

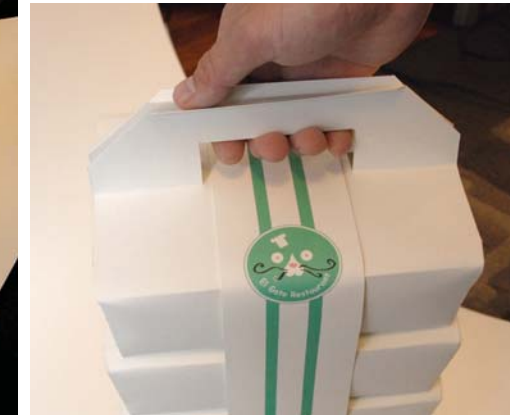
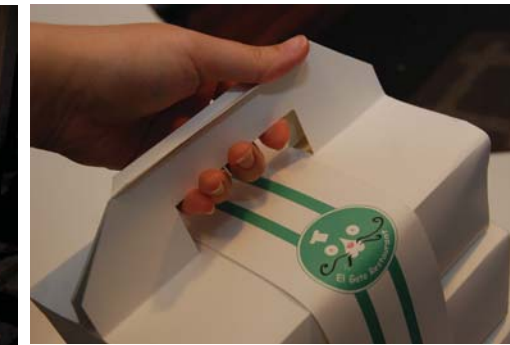
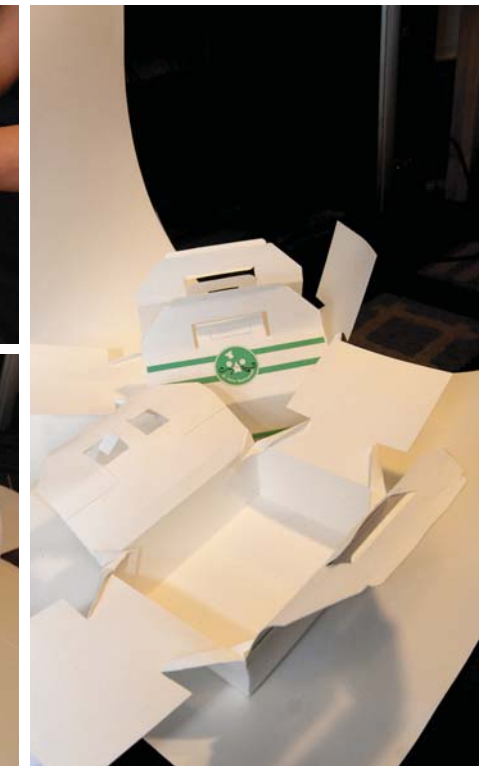

Orthographic

When designing a package, one of most important things is to make sure the design fit the manufacture's requirements. The width dimension of commonly used paper rolls is up to 43.5 inch (110.49 cm). The manufacturer can customize the roll size for the needs of specific client, but at an extra cost. However, if the design is made to fit the common paper roll size and is laid out to produce more products with less wasted paper, the company doesn't have to spend extra money for a custom-sized paper roll and will have higher profit on each production run.



Logo Design

A Package For Sustainable Restaurants

Due to the environmentally friendly materials and the special folding design, Takeaway is ideal for restaurants and customers that are concerned with environmental sustainability.

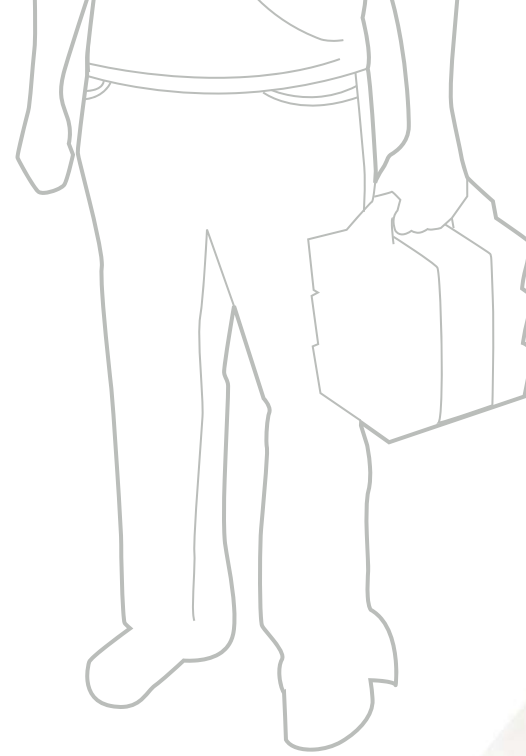
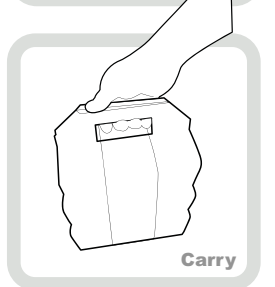
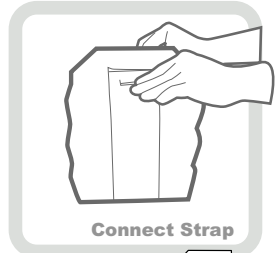
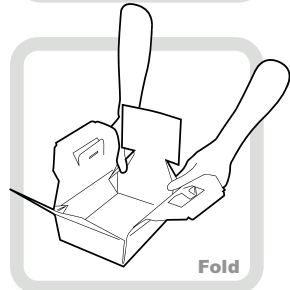
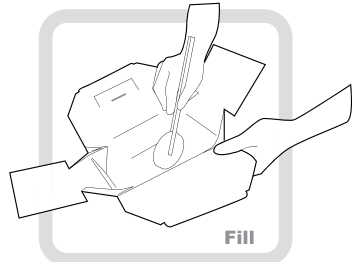
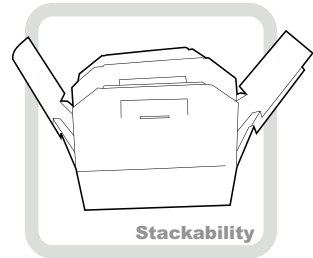

[Takeaway] Food Containers

Takeaway, using biodegradable materials and requiring less energy from manufacture to disposal, truly reaches the goal of sustainability and helps maintain well-being from environmental, economic, and social dimensions.

Design Features

- Better leak resistance
- No plastic bag needed
- Environmentally friendly
- Easy to store
- Comfortable to carry
- Compost symbol on the bottom which indicates to the customer that the container is biodegradable.



[Fishy] Fishing Gear

Fishing is suitable for all ages and a great way to have a pleasant time while you take a break, helping to release the pressures from daily life. When I go fishing, I always feel that there are things I could improve as an industrial designer. I would like to make fishing easier and more comfortable for any level of angler.





Inspiration

Fishing is an enjoyable escape from life's daily pressures; however, a lot of time when I going fishing with friends at a nearby pier, I see people carrying alot of equip- ment such as ice coolers, chairs, various containers, and sometimes a variety of fishing rods, all of which are a hassle to transport and carry around. As an angler, I also feel that the handles of existing rods are uncomfortable to hold for a long time.

Project brief

- Design a carrying system to help anglers transport different tools while they go fishing.
- Make a fishing rod that is easy to carry and com- fortable to use.

Fishing Carrying system. #1. * Modular type of carrier!

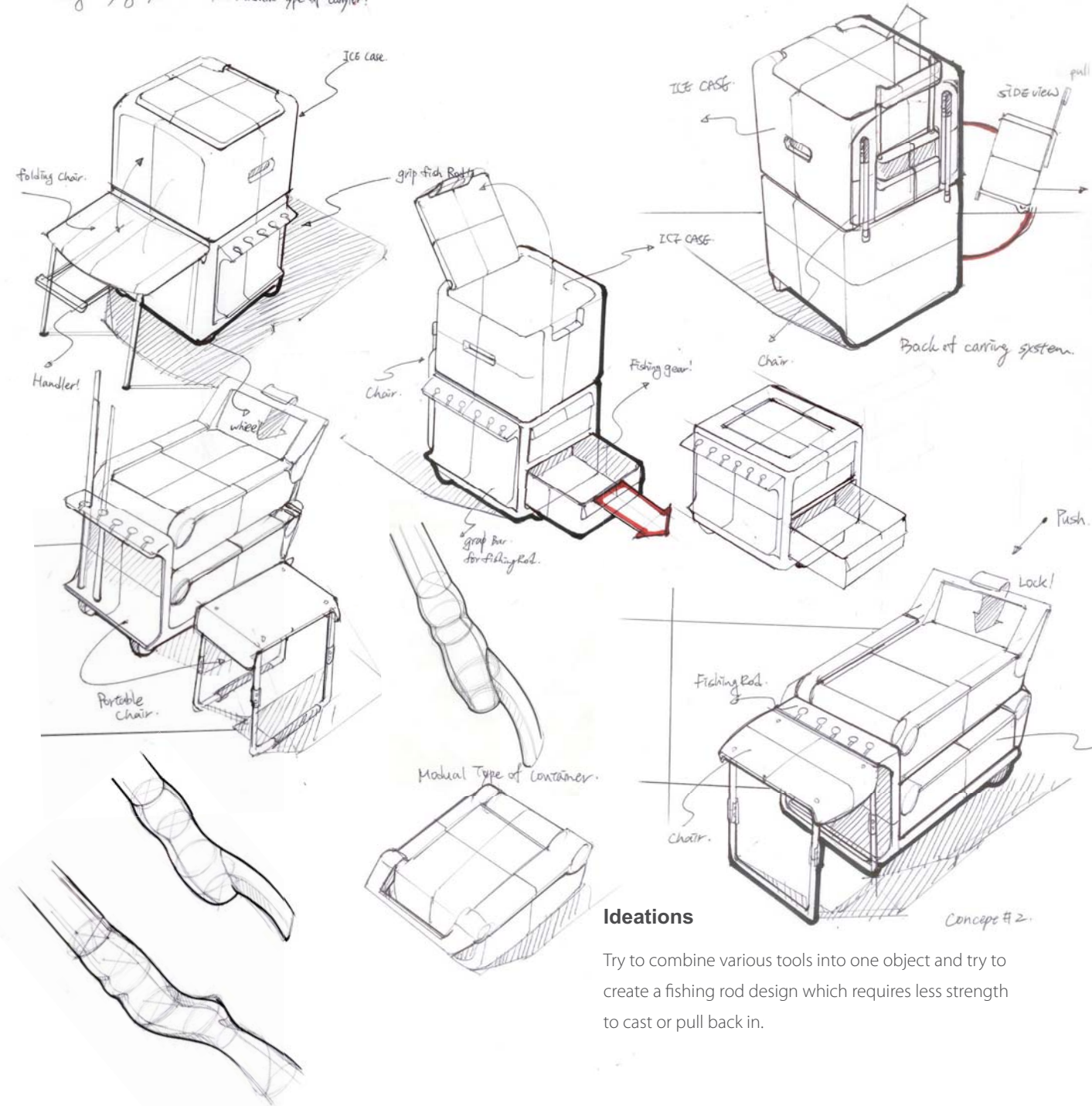

Ideations

Try to combine various tools into one object and try to create a fishing rod design which requires less strength to cast or pull back in.

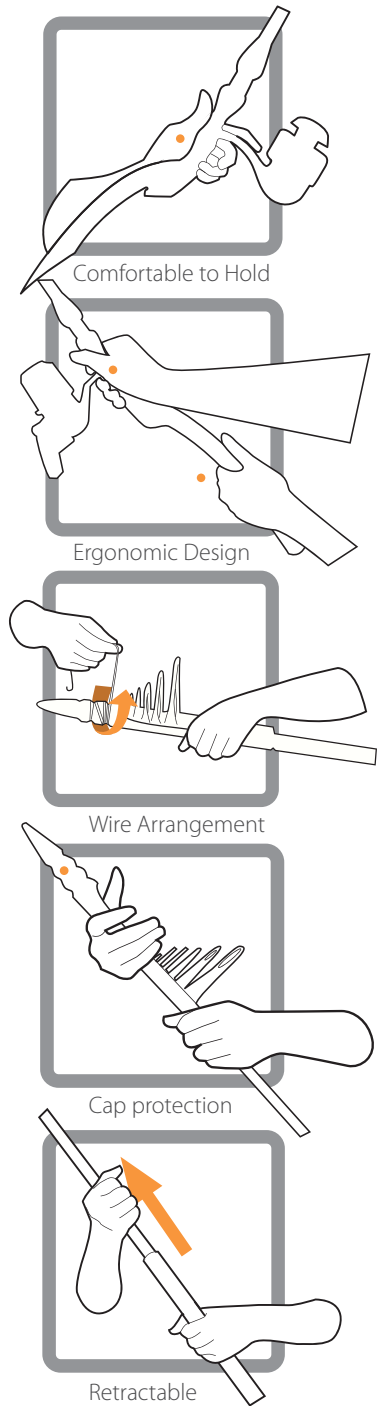

Ergonomic Fishing Rod
3D Modeling- Alias, Showcase

[Trackman] Tracking System for Efficient Rescue

Of all natural disasters, earthquakes have caused the highest number of deaths in the last ten years. Through my research, I realized that the current marking system used during the rescue process is not efficient and could cause many problems which would ultimately decrease the speed of rescue and require that rescuers spend more time in unnecessary search.

Project Goal

The goal of the project is to design a product that can enhance the speed of rescue during and after earthquakes.

Problem Statement

After an earthquake, rescue teams have to enter a collapsed building to conduct a search for trapped victims. However, the current marking system to identify areas that have been searched is not efficient. It causes redundant searches and is a waste of manpower.

Hypothesis

If there is a system which can record each team's working progress, the command center can have a better understanding and more control of the whole situation and rescuers can work more efficiently to save more people.

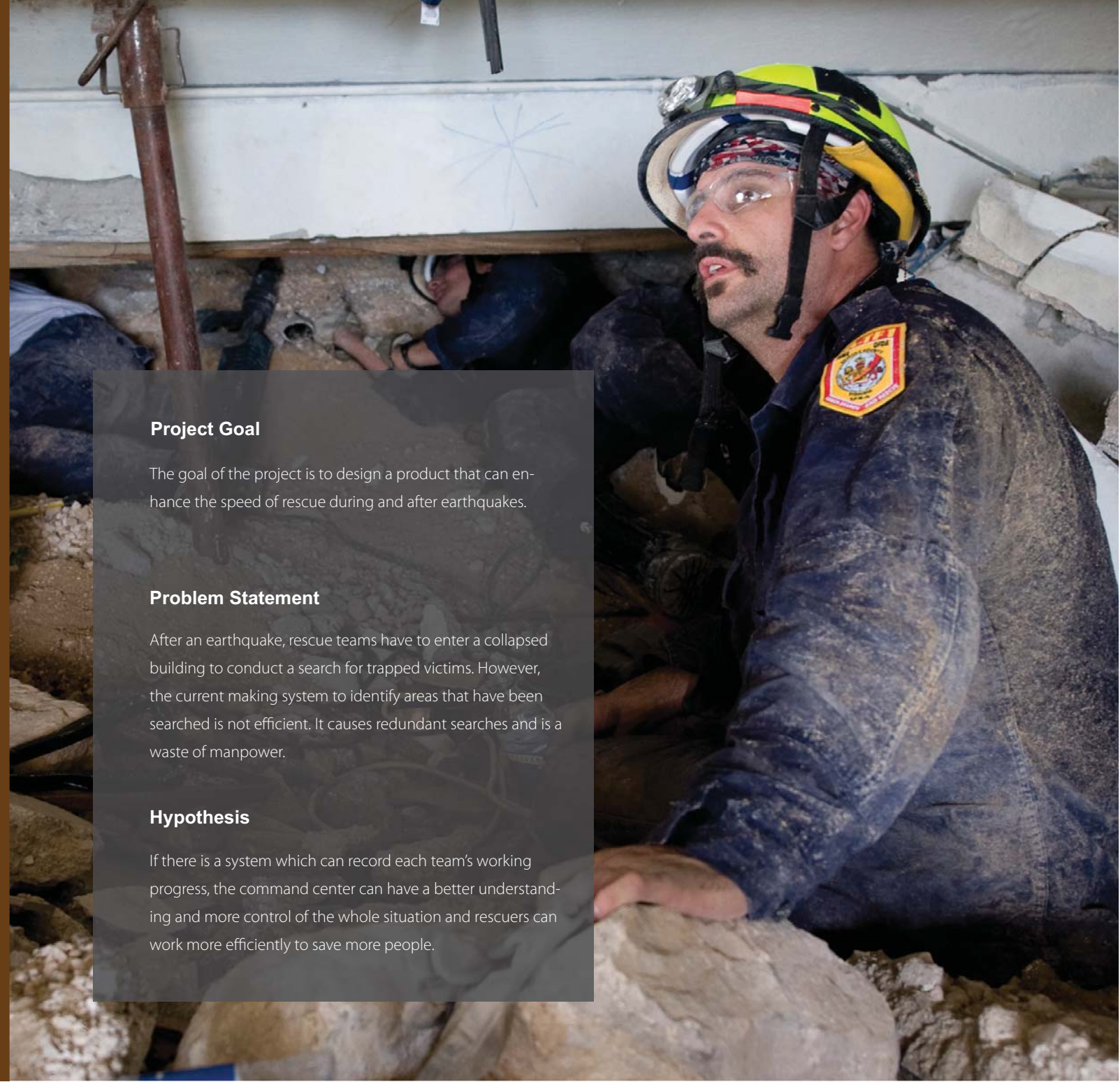

Why Do They Need a Tracking system?

Rescuers

In order to save as many lives as possible, rescuers face crucial time issues. However, during the rescue processes, the current marking system is inefficient requiring rescuers to approach a specific location to know whether or not the site has been searched.

Command Center

During the rescue process, command centers have to plan ahead and control entire search process. However, they rely on the rescuers' reports to organize the daily rescue status. Lack of real-time information update makes it hard to control and deploy rescuers in time.

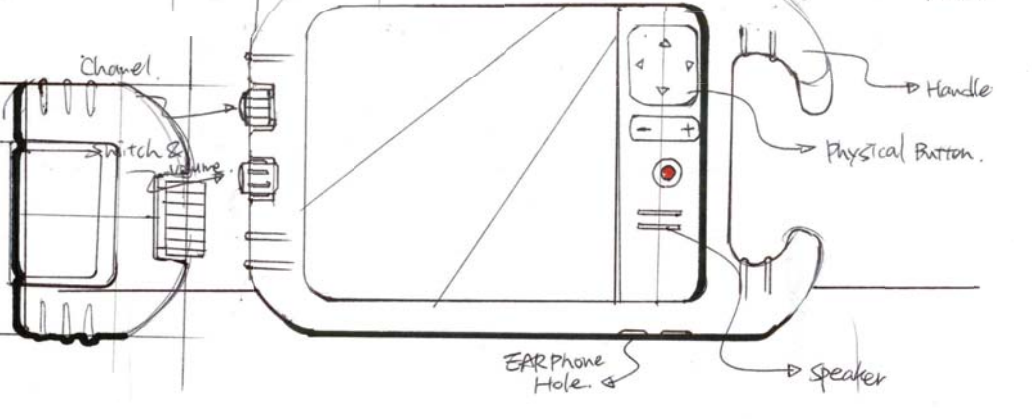
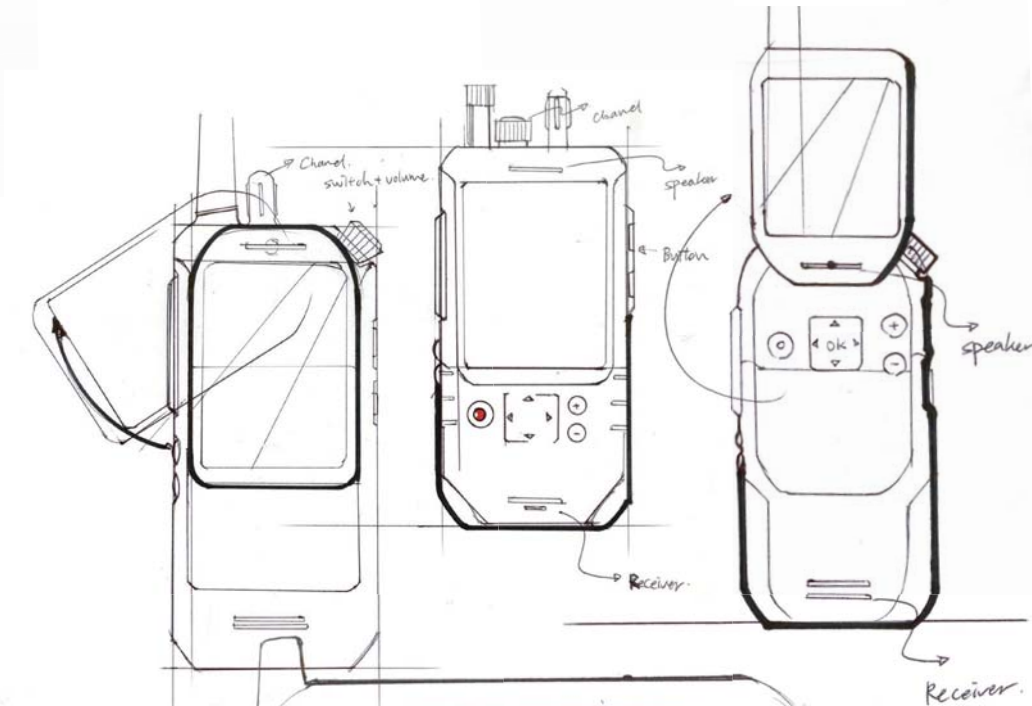
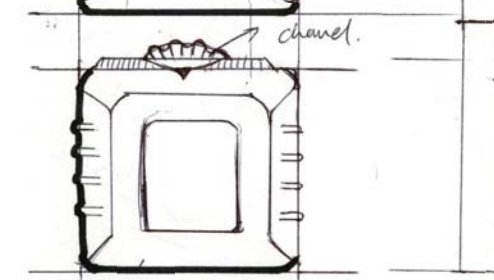
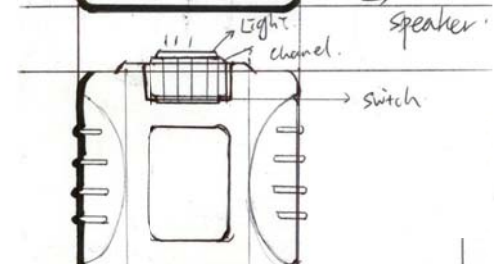
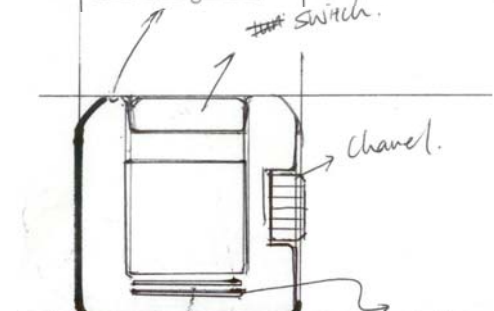
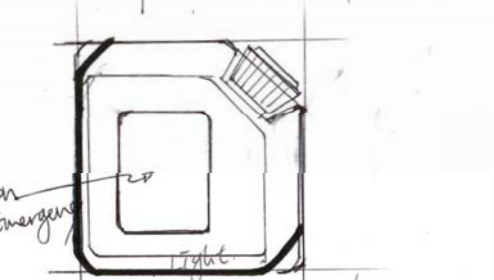
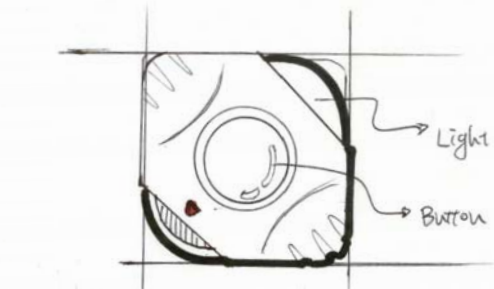

Ideation of Tracking Devices

Considering that rescuers always wear gloves during operations, physical buttons on a tracking device is a necessity. The team leader's tracking monitor could incorporate a walkie-talkie so they don't have to carry an extra device. The tracking device for teammates should be small, light, and easy to clip on to clothes.

User interface of leader's tracking monitor

1. Turn on the device



2. Language setting

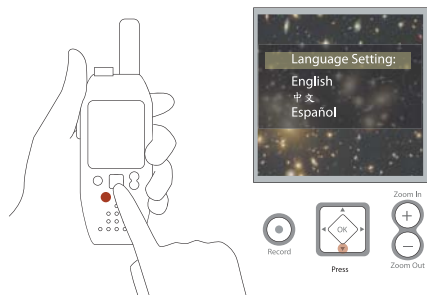

3. Choose one of the languages

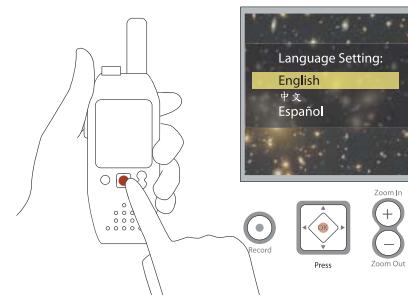

4. Welcome page



5. Start in GPS mode, showing the location of rescuers.



6. The command center gives the mission and team leaders receive the signal.

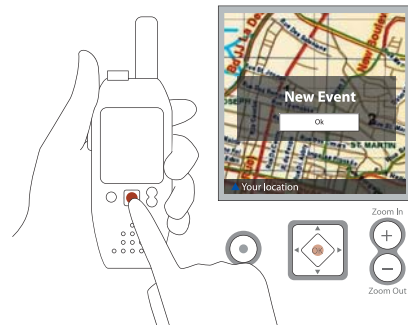

7. Receive the mission from the command center & use GPS function to get to the site

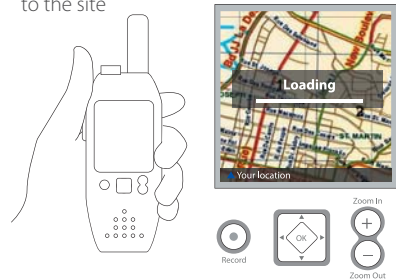

8. Check the information.



9. Device is showing the proper route for rescuers

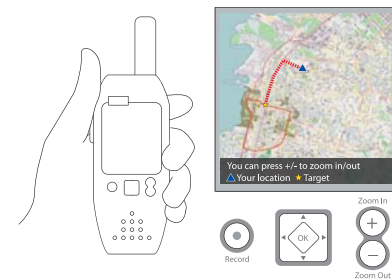

10. (If user wants to zoom in to see the map in higher detail) Press button to zoom in



11. Device is showing the proper route for rescuers



12. (If user wants to switch to different mode,) Screen will automatically show how to switch modes.

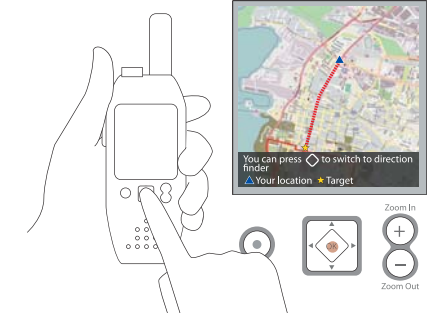

13. Direction finder mode

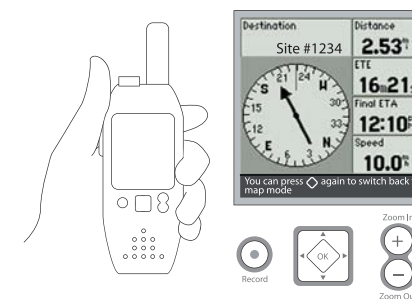

14. (If users want to switch back to map mode.) Follow the instructions to Switch back to the map mode.



15. Showing warning when you use direction mode to arrive the site.

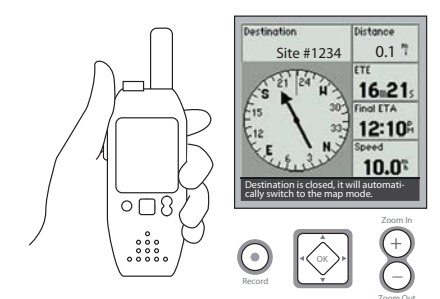

16. An audible alert is given when the user arrives at the site.

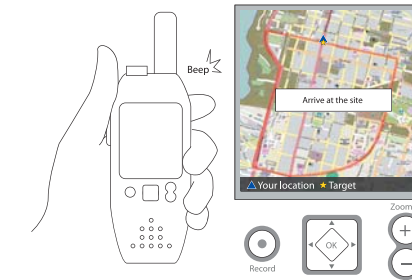

17. (After arriving at the site, rescuers may need to zoom in to see a clear map.)



18. Suggestions keeps showing up after rescuers arrive at the site.

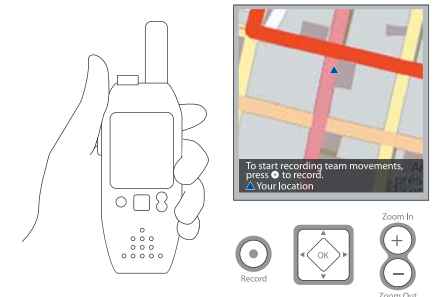

User interface of leader's tracking monitor(continued)

19. After rescuers arrive the site. Leader start recording team mates movement

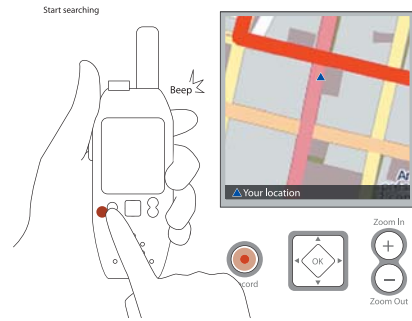

20. (When rescuers start searching.) During rescue, suggestions will show up to help users understand how it works.

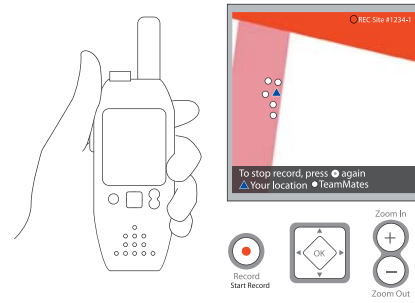

21. Leader sends two search specialists in the building. Tracking record will change the colors as time passes.

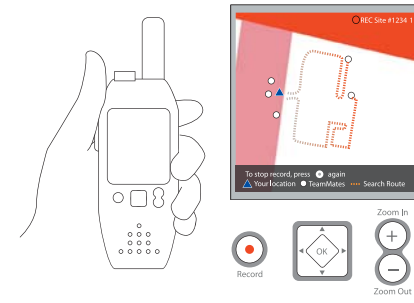

28. Rescuers bring back the victims and finish the search in this site

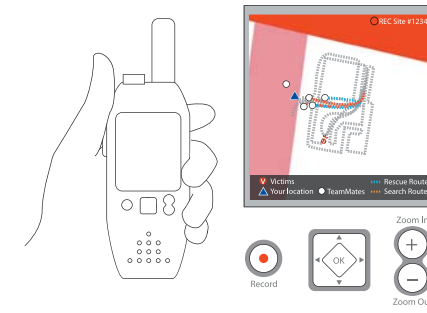

29. Finish search, press the record button to stop recording.

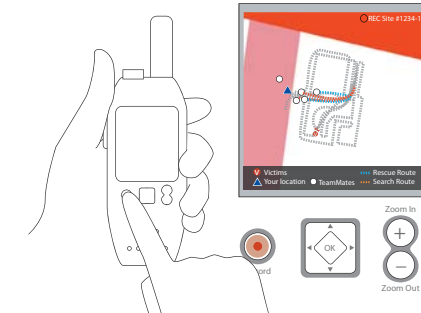

30. After rescuers finish the site.

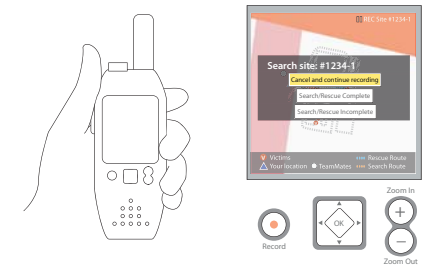

22. The two search specialists move to the target location.

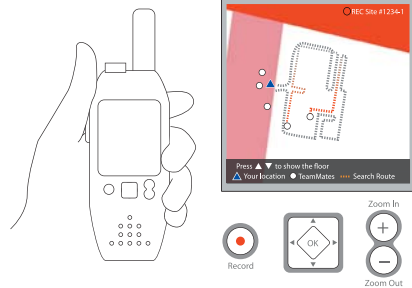

23. (If leader wants to switch floors, ex: he knows this is a 2-story building.)

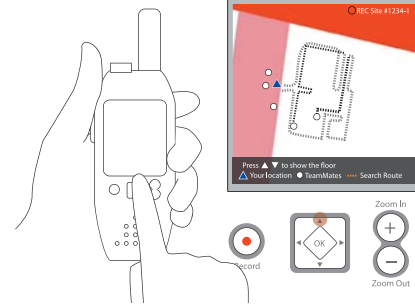

24. This feature helps leaders read the information when they are searching a multi-floor building

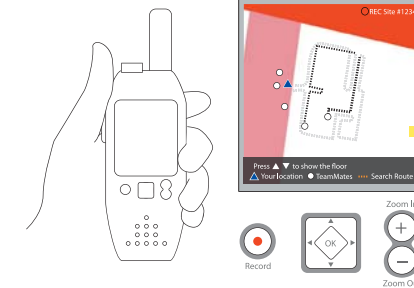

31. Choose correct item

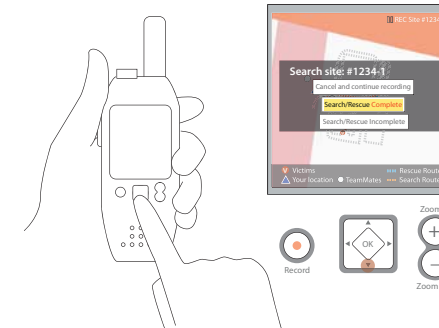

32. Click "ok."



33. Sending information.



25. (One of the rescuers finds a victim and presses his transmitter.) Sound a beep to notify leaders.

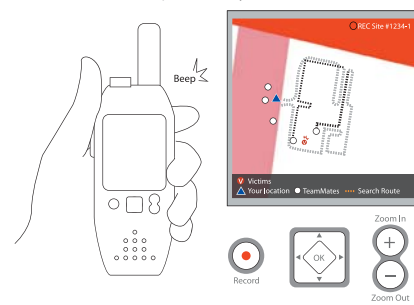

26. (Leader sends two rescue specialists to rescue victims). Add support to help (screen shows two new lines)

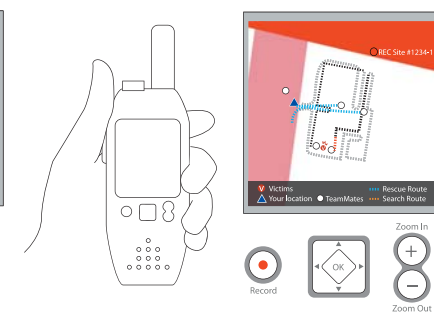

27. Successfully approach the position.

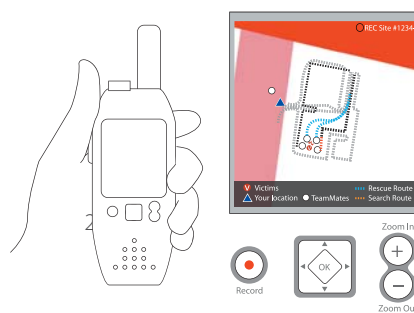

34. Respond information successfully sent.



35. Device automatically goes back to map mode. Completed site indication shows on the map. (Hold for 5 Secs and it will automatically change to the next scene).

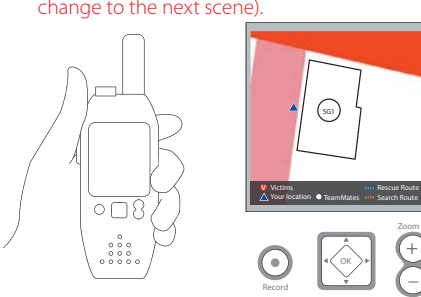

36. Back to the main map, and rescuers can search the next area.



User Interface for Command Center

How command center sends the mission to rescuers.

- 1 Rescuers have the tracking devices and command center is ready to send out the mission.

In Command Center



- 3 How the command center uses this system to send out the mission.

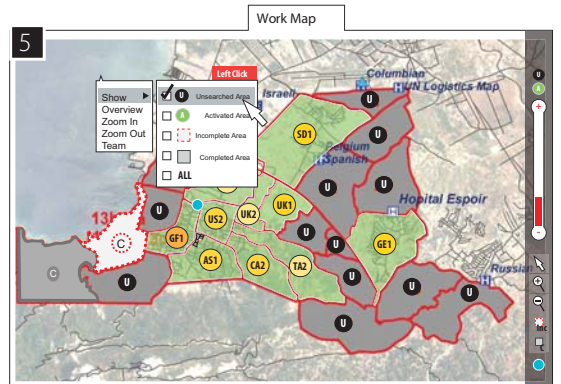
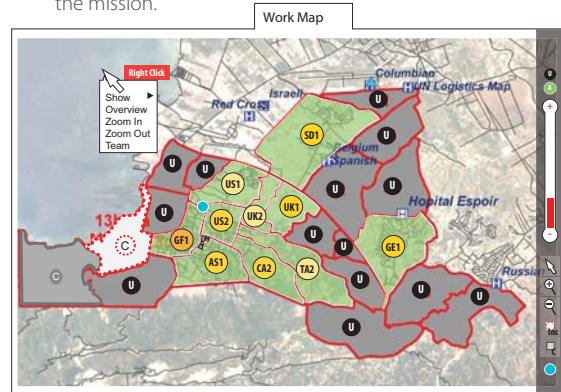

- 2 Office turn on the system. On right side are short-cuts. Explanations appear when hovering mouse pointer over the icons.

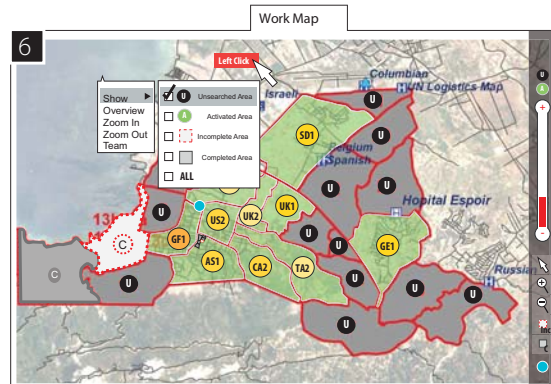
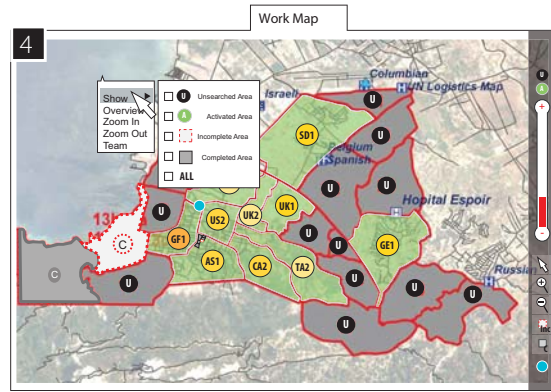
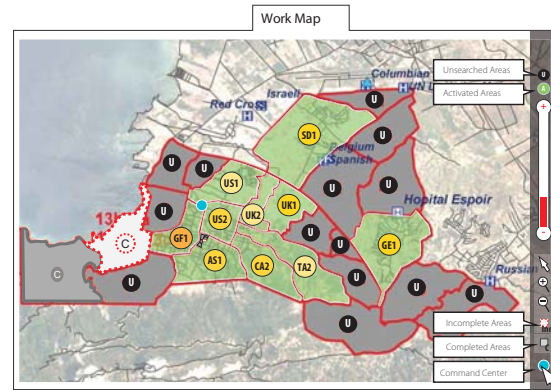

- 7 Only show unsearched areas.

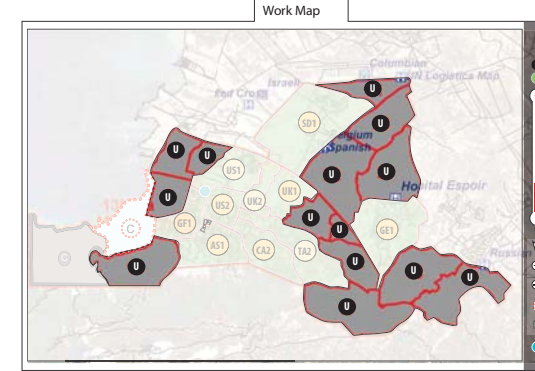

- 9 The location of suggested teams sorted by distance.

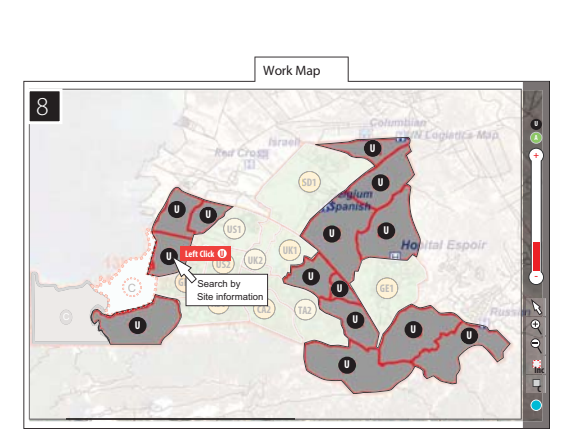
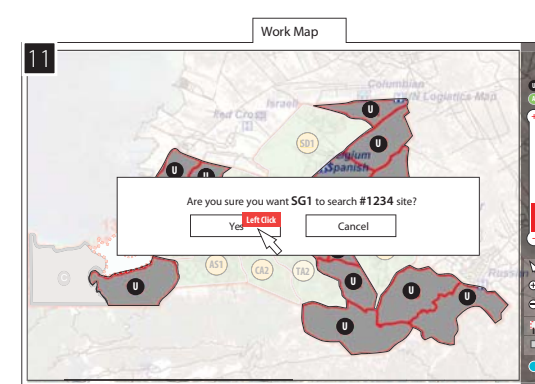
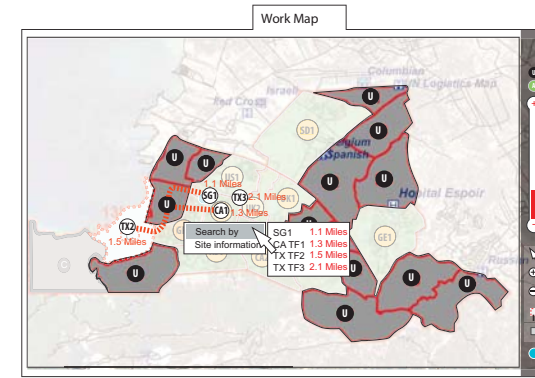

- 10 Choose a team.

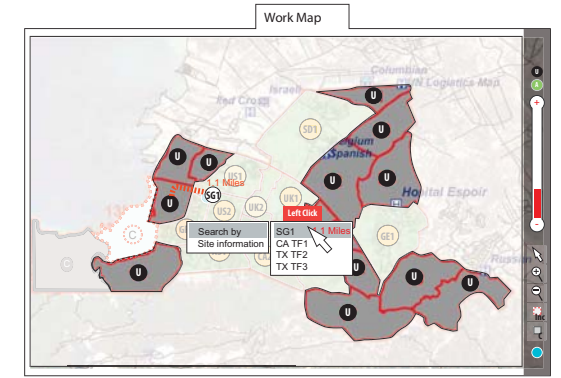

- 12 Send out the mission.

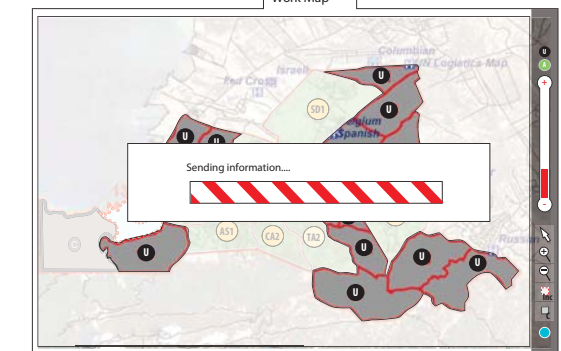

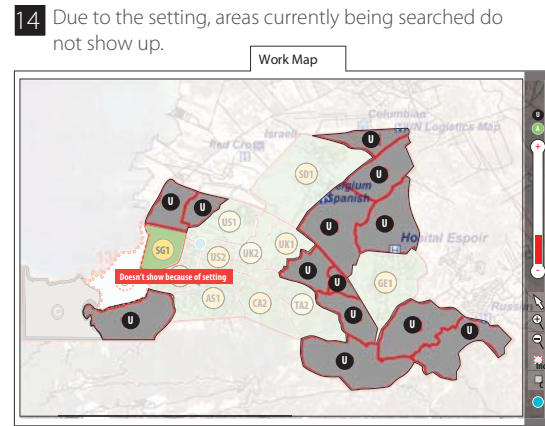
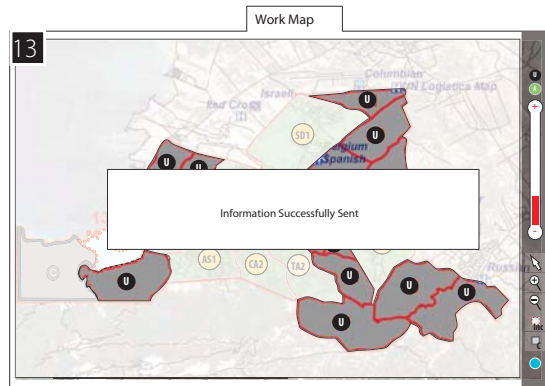

How command center checks the rescue teams' status

1 If the command center wants to check SG1 working progress...

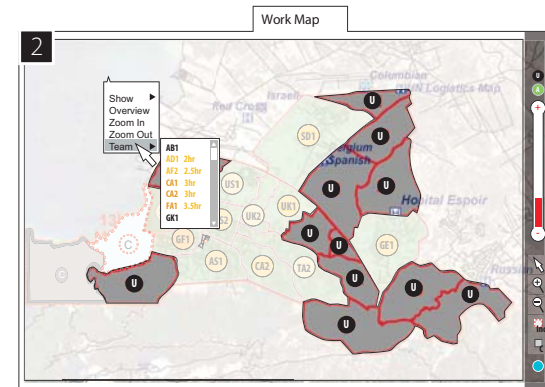
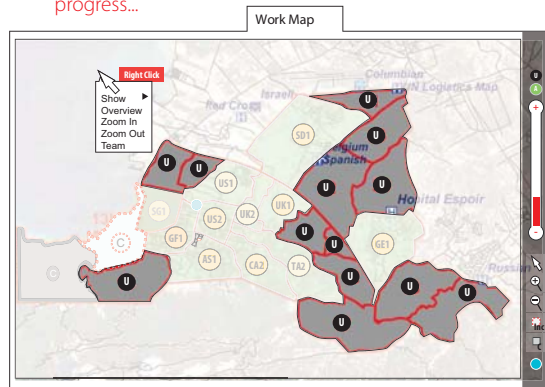

3 Press "S" on keyboard to show all the teams starting from "S"

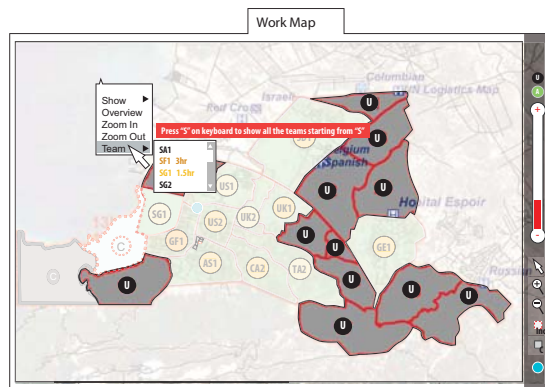

4 Float on top of the name and team's location and brief information show up.

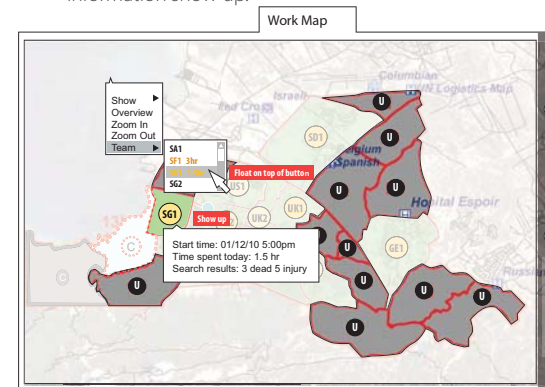

5 Click the name.

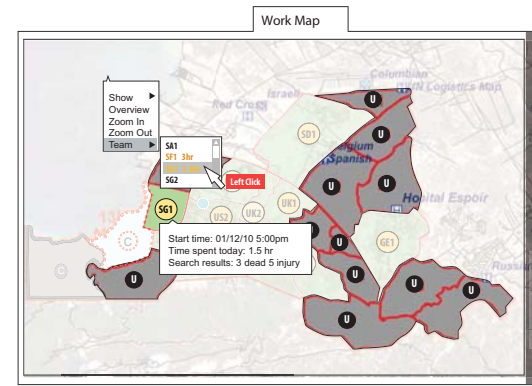

6 Show the location of team.

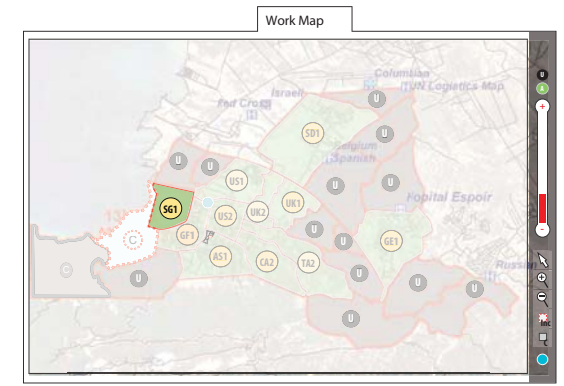

7 Float on top of button, brief information shows up.

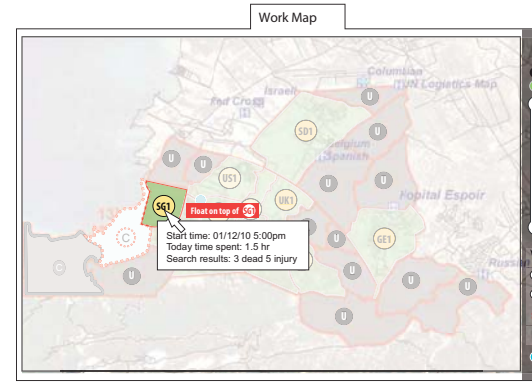

8 Click the button, further commands show up.

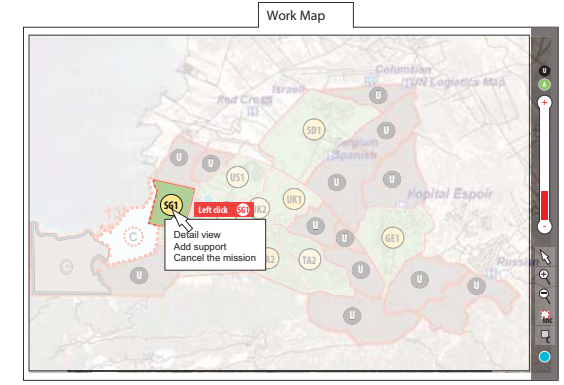

9 Click "Detail view."

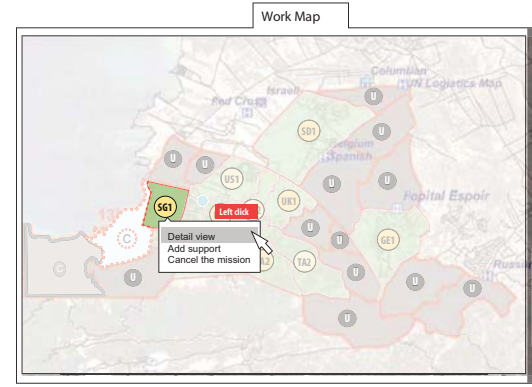

10 Screen will show the detailed location. Officer can zoom in to see the searching status.

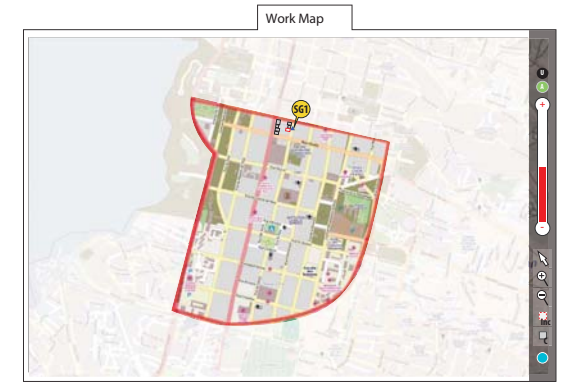

Orthographic

Monitor

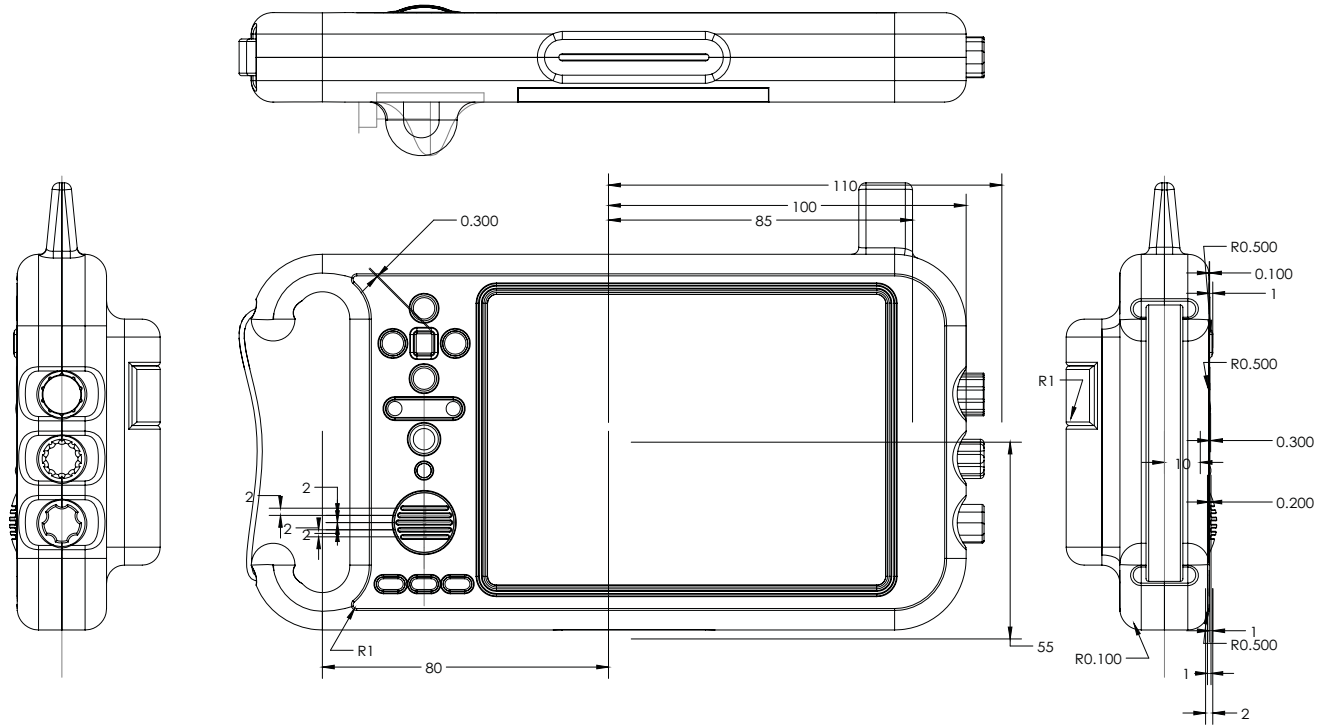

Tracking beacon

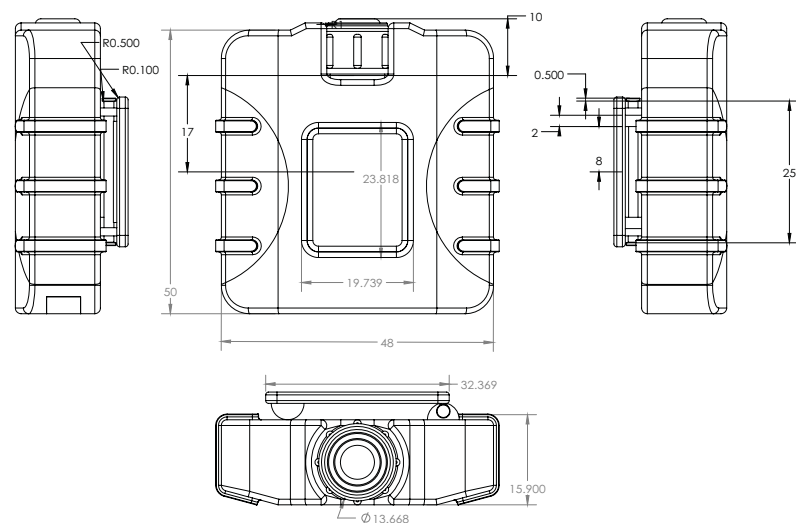

[Trackman]



[Biocan] Compost Container

Every year, over 200 million pounds of trash enter landfills in America, and about 15 percent of the garbage is waste from kitchen and yard scraps. Instead of this waste entering the landfill and taking up space, it can be composted and turned into a nutrient-rich soil which can be used to help grow the next generation of crops.





See

No one likes to see the contents when they open the compost bin. Therefore, I designed a small mechanism which lifts up a cover when the bin is opened to prevent the user from directly seeing the contents inside.

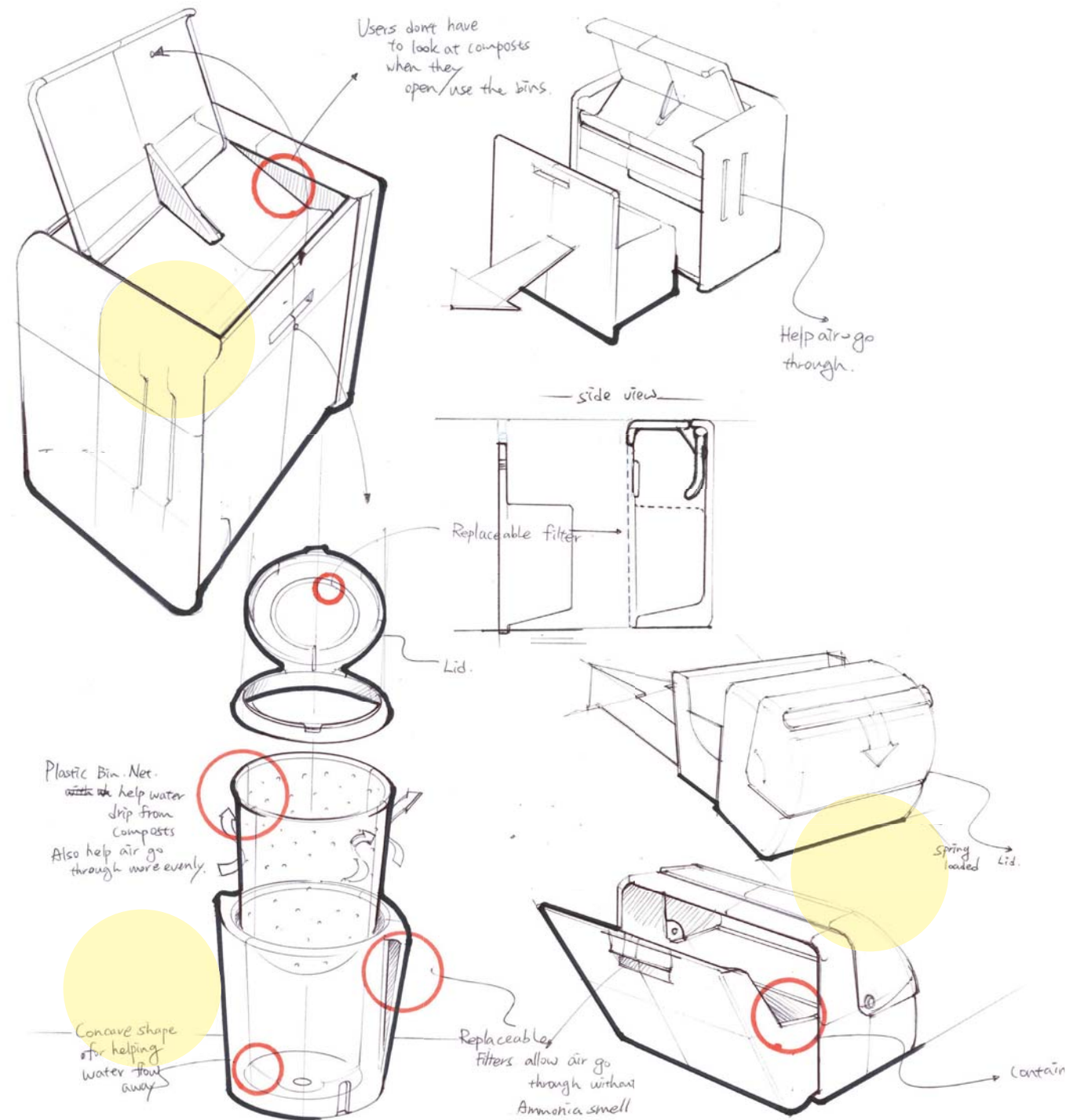



Being Environmentally Friendly Starts In Your Kitchen

Designed with the home cook in mind and attractive enough to live on the countertop, this handy bin stores food scraps until they can be transferred to an outdoor composter.

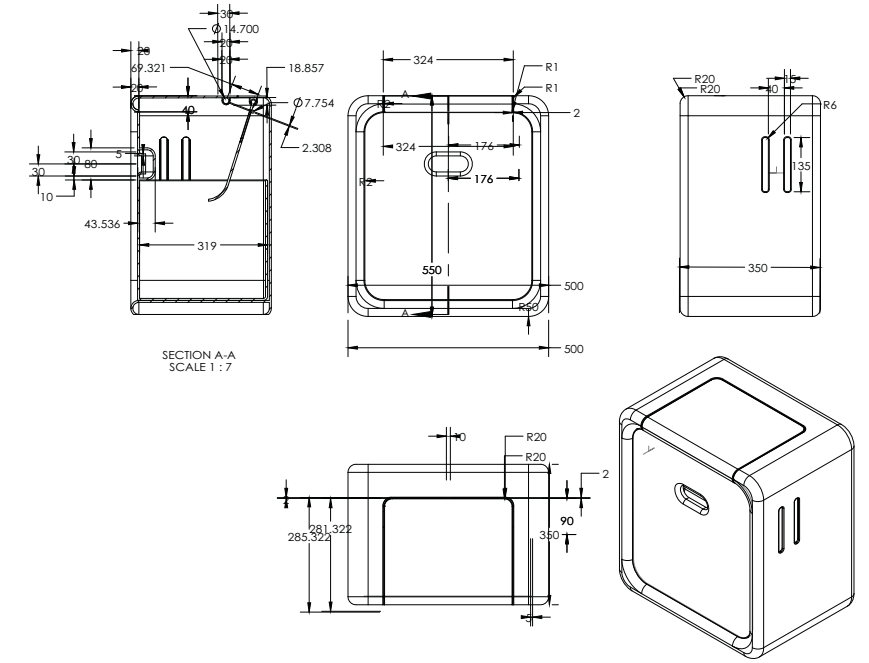

Smell

No one like odors at home. However, in order to quickly break down decomposing organic materials, air circulation is necessary. To solve the problem, the design incorporates an odor-locking carbon filter which is installed in airing slots on both of the side of walls to help air flow in the compost bin.

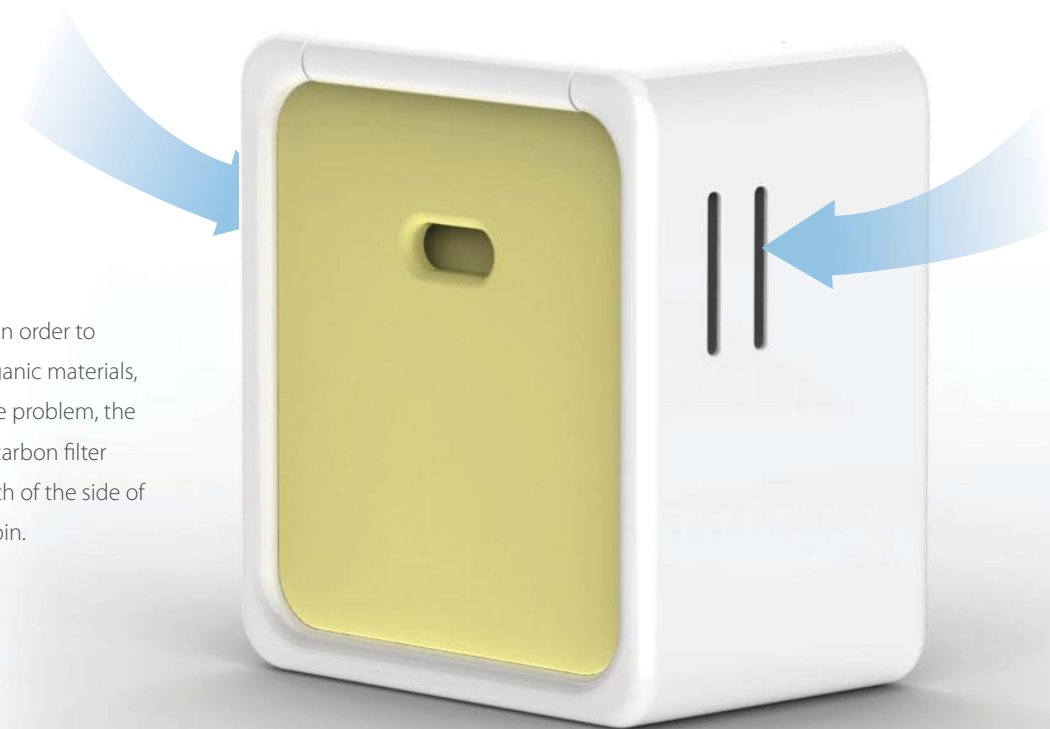

[Substitute] Shoe Design

People can customize the pattern on their shoes, why not the cushion? There are people of varying weights and varying ages. They all have different needs waiting to be satisfied.

Substitute is my concept which allows the user to customize their cushion support depending on their needs.





Inspiration

My dad is overweight but he likes to go hiking or jogging in the morning. However, he has gout, so his heels are pretty sensitive. If he wears a shoe which can not give him enough support, the next day his heels are going to hurt.

He always spends a lot of time looking for a running shoes, but it is hard to find one which can make him feel satisfied.

I have seen a lot of middle-aged people who have the same problems of having extra body weight because of spending too much time in the office, and when they try to work out, diseases of civilization reduce their quality of life.

If the shoe cushioning can be customized, then not only can it give the feet proper support, but it could make exercise more comfortable for all types of people.

Concept Development: Upper



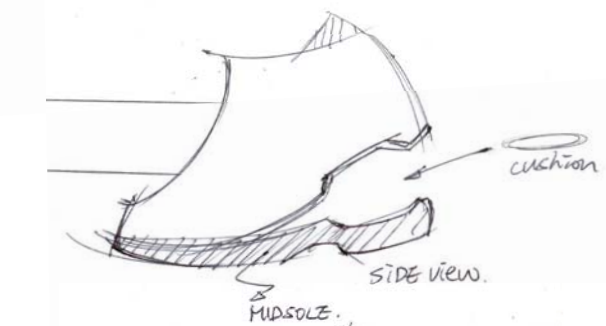
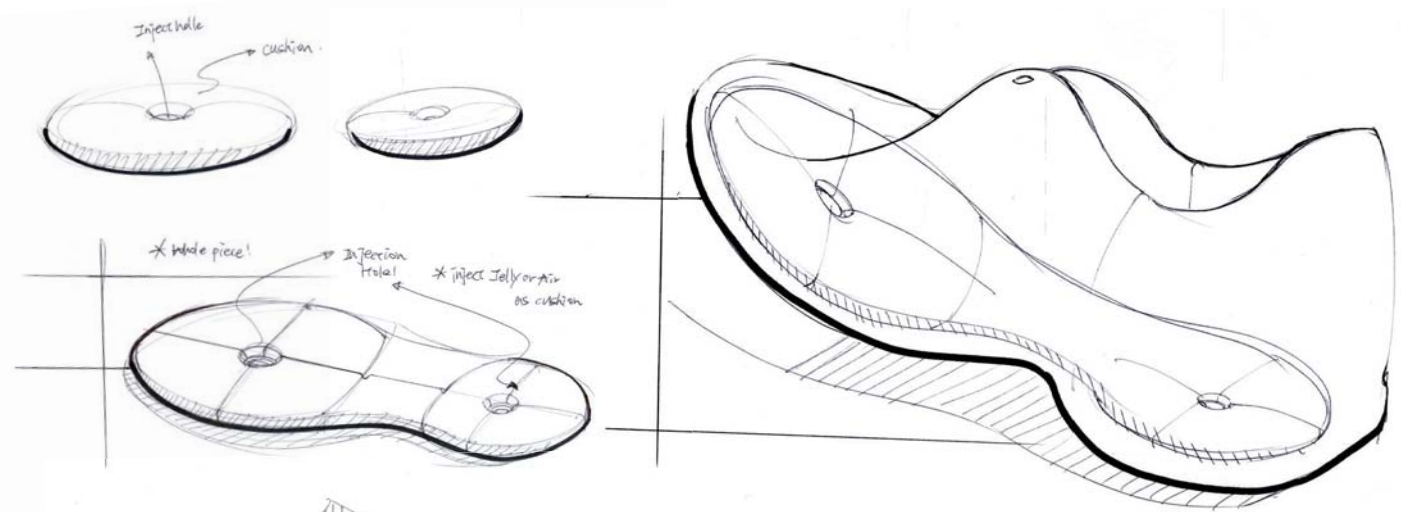

Design Features

In order to insert the customized cushion, I designed a clamp-type of opening to allow the user to install the cushion.

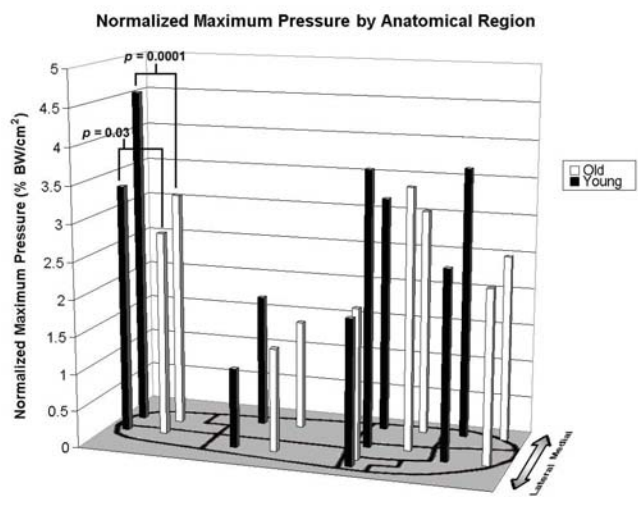
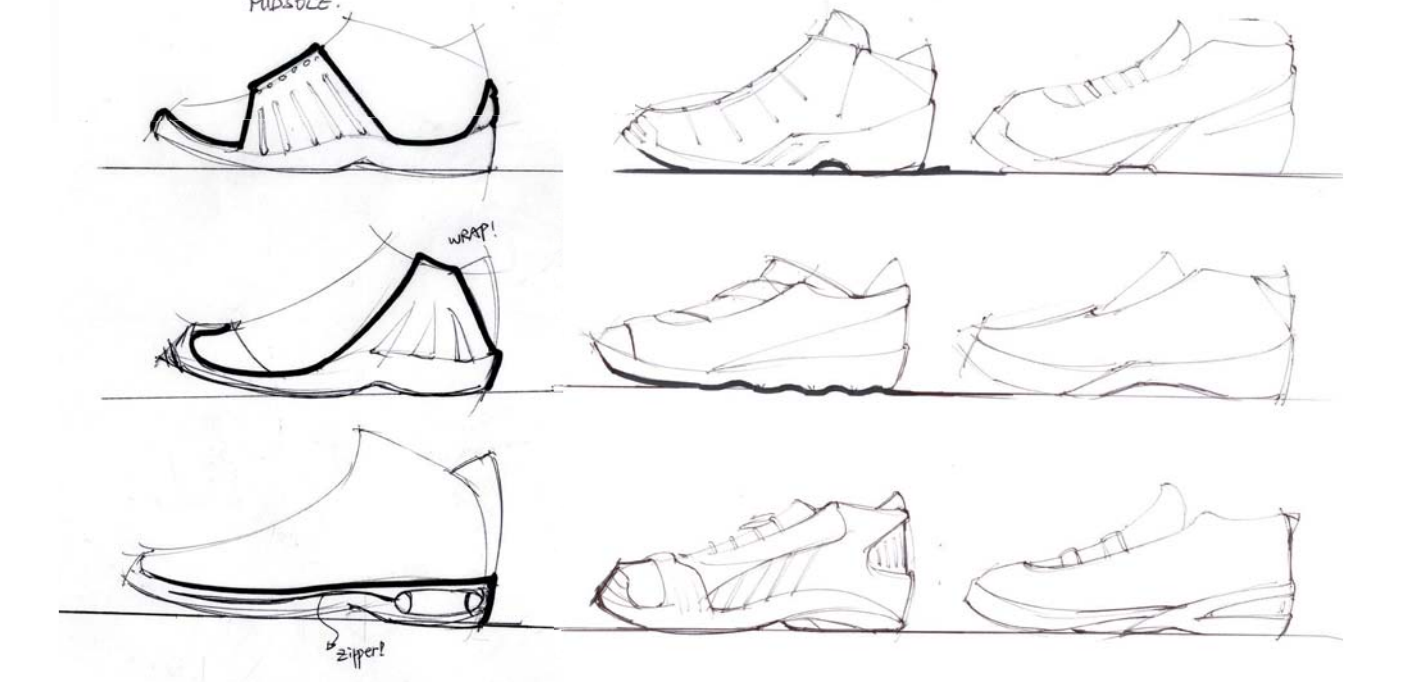

Why do we need customized cushion?

Based on research, the heel is the area where the most forceful impact occurs. It takes the most pressure from the weight of the body. If one wears poorly fitted shoes, it may cause back and foot pain. Finding the proper shoes, however, can be a tedious and expensive process.

User Scenario

In the store, an assistant will help the customer measure their foot pressure. Based on the results, the assistant will insert the jell or air into the cushion and then seal it. The assistant will open the midsole and insert the customized cushion to complete the process.



Orthographic View

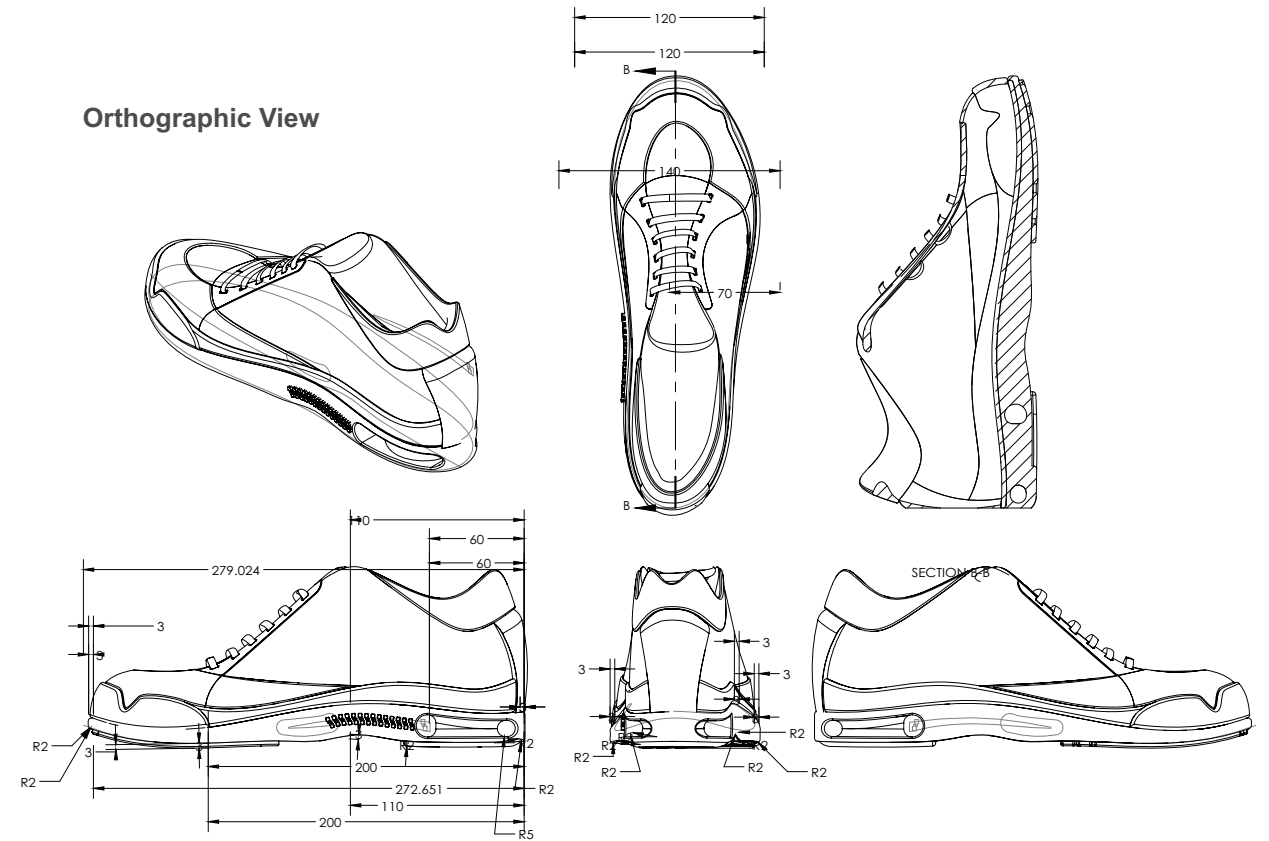

Side View

【 Peak 】 Coffee Maker

Modern, elegant, and compact. This coffee machine was designed to be a timeless classic with modern avant-garde design.





Concepts

Inspired by modern furniture and environment.

The easy, mess-free way to brew up a perfect cup of coffee.

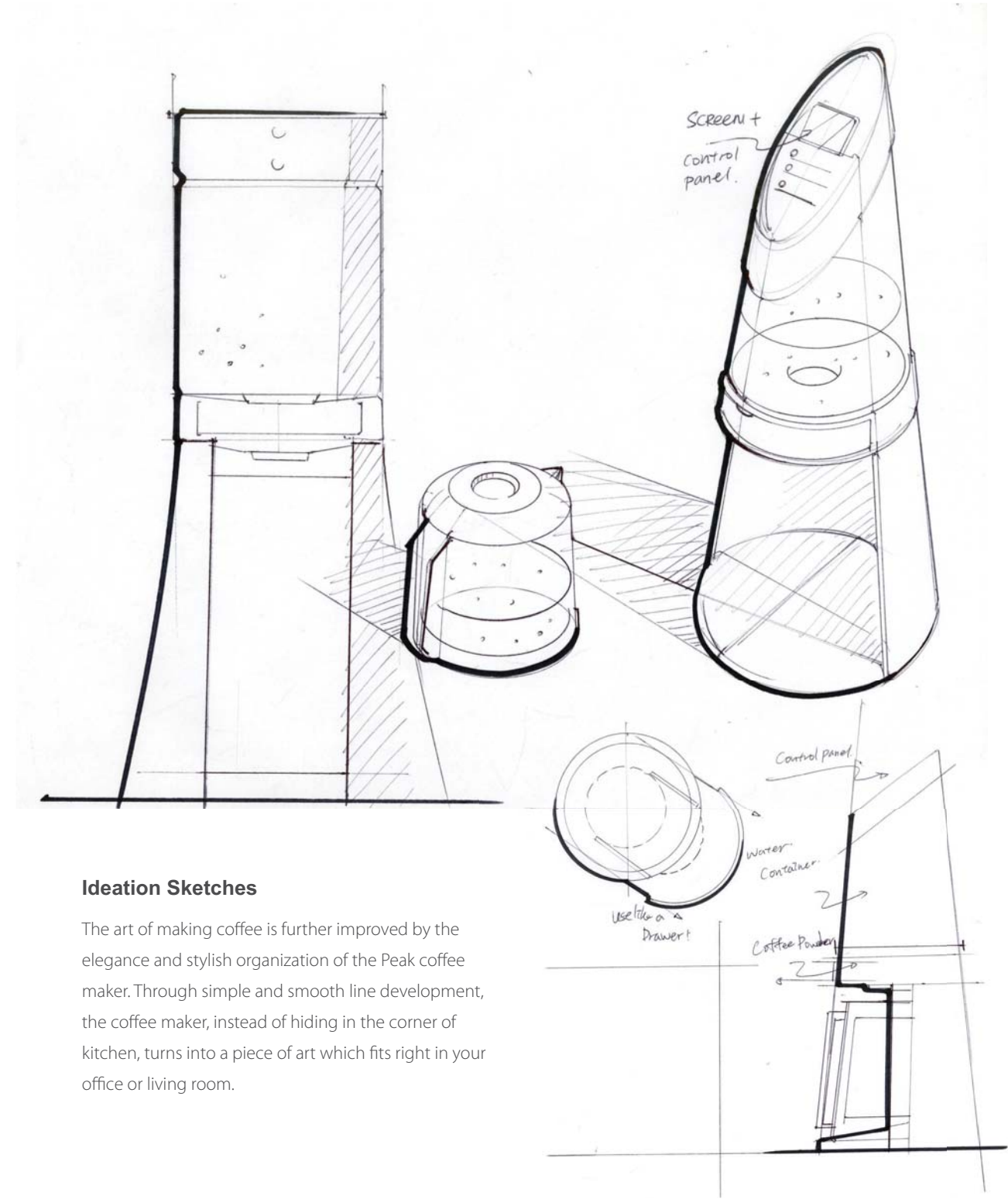

Ideation Sketches

The art of making coffee is further improved by the elegance and stylish organization of the Peak coffee maker. Through simple and smooth line development, the coffee maker, instead of hiding in the corner of kitchen, turns into a piece of art which fits right in your office or living room.

Design Features

- Exclusive design.
- 10-cup thermal carafe to keep coffee warm for hours.
- Illuminated buttons for easy use.
- Automatic shut-off for safety.
- Water level indicator windows on either side to show when it needs to be refilled.
- Anti-drip function.
- Compact design.



3D Modeling- Alias, Showcase

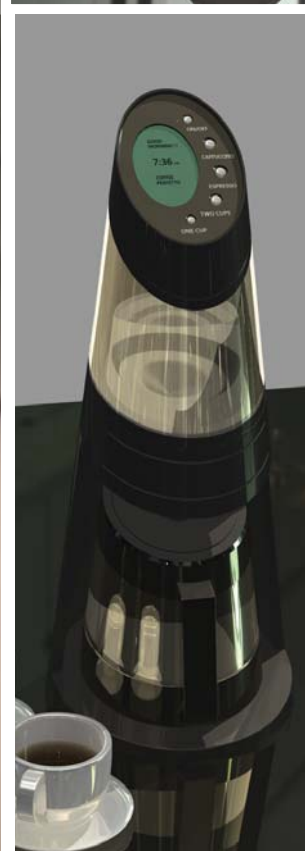

[Peak]



Claire Fanyi Meng

mongfanyi@gmail.com

Claire_meng@hotmail.com

240-499-4635

MFA Industrial Design

Academy of Art University